

VCC13

THIRTEEN



NISSAN/INFINITI REAR ADJUSTABLE ENDLINK INSTALLATION INSTRUCTIONS:

2003-2008 NISSAN 350Z Z33

2009+ NISSAN 370Z Z34

2003+ INFINITI G35 SEDAN & COUPE V35

2008+ INFINITI G37 V36

1999-2005 MAZDA MIATA NB (FRONT AND REAR)

PART NUMBER:

ADEL-0300

We recommend that installation of all Voodoo13 parts be completed by a professional who is experienced in suspension tuning. With proper installation and maintenance, Voodoo 13 suspension products will provide exceptional performance and durability. For any questions, please contact Voodoo 13 immediately. We thank you for choosing Voodoo 13 for your suspension tuning needs!

NEED HELP?

Our representatives are here to help you with any questions concerning the operation of this product.

CALL 480-889-0812

Monday thru Friday 8:30am to 5:30pm MST

RECOMMENDED TOOLS AND SUPPLIES

- General Mechanics Tool Set
- Jack and Jack Stands
- 14mm Socket or Wrench
- 17mm Socket or Wrench
- Torque Wrench
- Anti-Seize Lubricant

PART BREAKDOWN

NOTE: For any OE hardware please refer to OEM service manual for torque specifications. For all included hardware, please torque to specifications shown below. It is recommended to use a torque wrench when tightening instead of an impact gun and apply anti-seize on all threads.

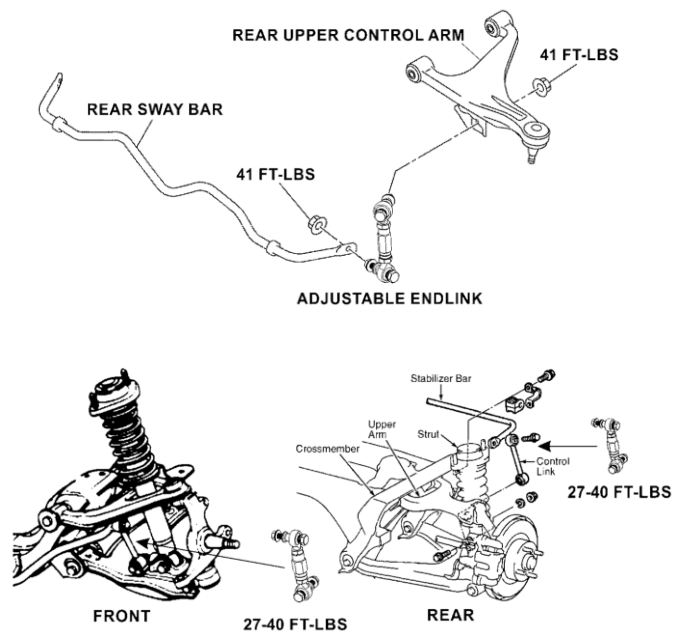

INSTALLATION PROCEDURE

Step 1: Lift the vehicle to a safe height using the recommended factory lift points to work underneath the rear suspension. Ensure to place safety jack stands where recommended by the manufacturer's service manual before anyone goes underneath the car (unless using a vehicle lift with safety locks).

Note: If you are able to lift the entire rear suspension where the rear wheels are off the ground, this will ease the process of removing the factory endlinks. If you can only lift one side of the vehicle, you'll need to use a floor jack on the lower portion of the knuckle to relieve the tension on the sway bar.

Step 2: With the car in the air, begin by removing the nuts that are holding the sway bar endlinks onto the rear upper control arm with a 14mm wrench or socket. Ratcheting end wrenches will make the job much easier. Disconnect the endlink from upper arm bracket.

Step 3: Use a wrench and 14mm socket & ratchet to remove the lower portion of the endlink.

Step 4: Adjust the endlink to the same length as the factory endlink. Measurement of the endlink is taken by measuring from the center of one ball joint to the other.

Note: Increasing from the factory endlink length is a fine way of increasing the spring rate of the sway bar, however take into consideration the length of the sway bar does not interfere with anything else such as the lower control arms or the chassis itself . Also since the endlinks are independently adjustable in length, you can dial out preload in the sway bar. Preload in the sway bar can be result of corner balancing a vehicle with height adjustable shocks or struts or an uneven height in the suspension.

Step 5: Reinstall the endlinks with the entire car on flat ground to eliminate preload. Install one endlink on one side. Then install on the opposite side, upper bracket first. Then adjust the length of the endlink until the other bolt easily inserts in to the sway bar. Then use a 17mm wrench for the head of the bolt and 14mm wrench to tighten the nut to **41 ft-lbs**.

Step 6: Once the lengths of the endlinks are established, tighten the jams nuts against the hex rod. Then you are finished.

WARRANTY

All products sold are subject to the following warranty:

Voodoo13 offers a Limited Lifetime Warranty for our products to the original retail consumer against defects and workmanship when used on light truck and car applications under normal operating conditions. This warranty does not apply to parts that have been improperly installed or wearable items such as, but not limited to, worn bushings or bearings unless proven to be defective from the manufacturer.

Exterior finish on all Voodoo13 products is not considered a valid warranty; consumers are responsible for the maintenance of paint, anodize or raw metal finish.

The consumer will be responsible for the removal and freight costs both to and from the Distributor from which the product was originally purchased. Proof of purchase and product registration through the Voodoo13 website is mandatory in order to receive warrantee replacement; original invoice from the Distributor from which the product was purchased must accompany the product in question for warrantee.

Voodoo13 has the right to refuse a warrantee claim if procedures are not met by the original consumer. All returns must have an R.M.A. approval from Voodoo13 prior to shipping direct to the Voodoo13 facility. Exclusions from this warranty are sales outside of the United States, the finish, dents, rust, or any condition caused by abnormal use or neglect.

WARNING

High performance parts. For off-road use only. Installation should be carried out by a qualified facility. Improper use or installation may result in injury or death.



VOODOO13
254 W Broadway Rd
Mesa, AZ 85210
Ph: 480.889.0812
Fax: 480.829.8103
www.VOODOO13USA.com