



INSTALLATION INSTRUCTIONS

21-864C (Gun Metal Gray Finish)
TOYOTA
2019 Corolla
L4-1.8L

NOT LEGAL FOR SALE OR USE ON ANY POLLUTION CONTROLLED MOTOR VEHICLE IN CALIFORNIA OR STATES ADOPTING CALIFORNIA EMISSION PROCEDURES.

See aemintakes.com for CARB status on each part for a specific vehicle

TOOLS NEEDED:

ratchet
 extension
 10mm socket
 10mm wrench
 phillips screw driver
 flat blade screw driver
 3mm allen key

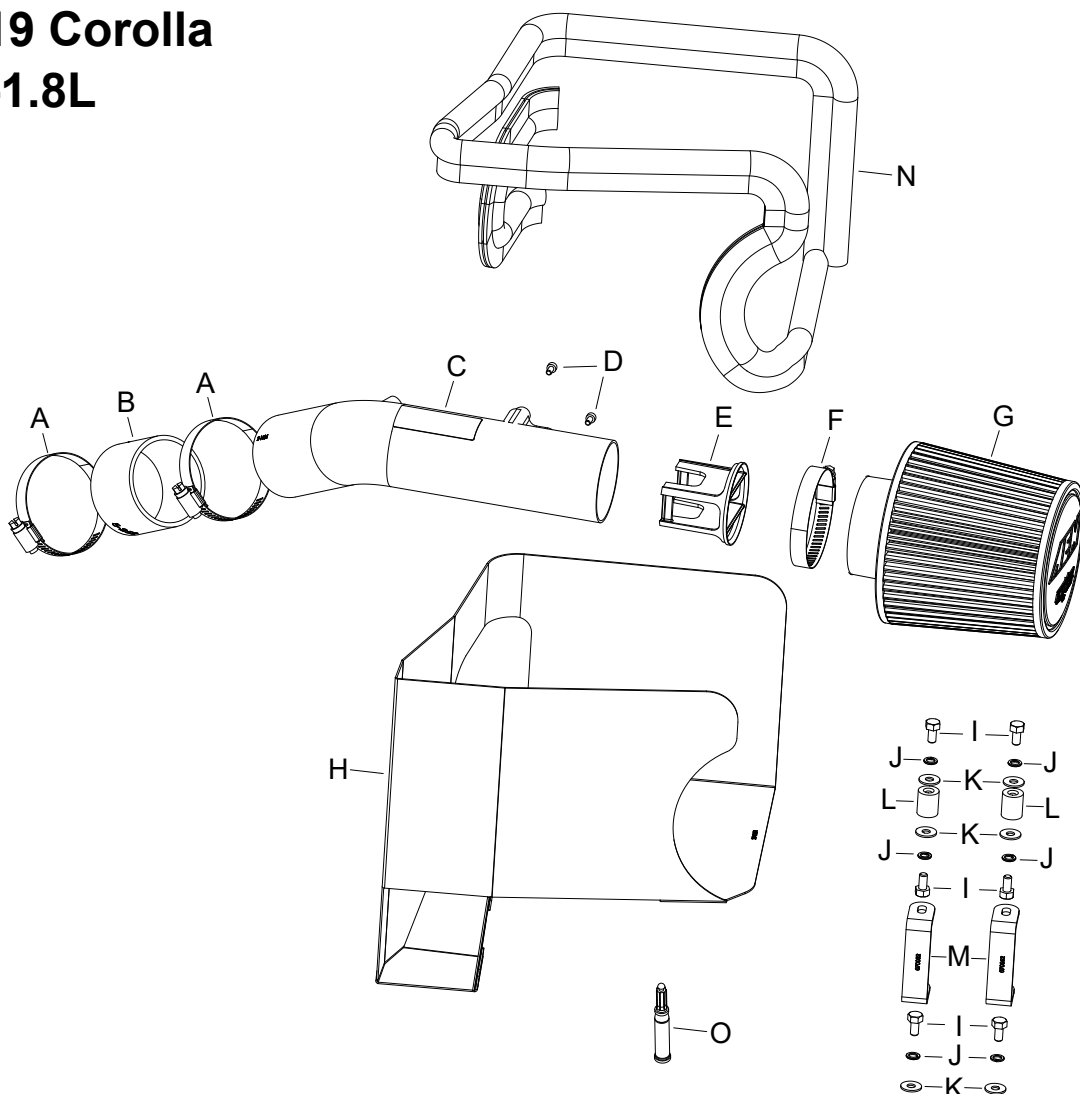

PARTS LIST:

Description	Qty.	Part #
A HOSE CLAMP; #40	2	08554
B HOSE, SILICONE 2.50X2"	1	5-252
C TUBE; 2.5"OD X 11" GUNMETAL	1	2-1634C
D BOLT; M4-.7 X 8MM, ALLEN, SS	2	07733
E MAF INSERT; AIR STRTNR	1	9-686
F HOSE CLAMP; 2.31"-3.25"	1	9444
G AIR FILTER; 2.5" FLG, 5-1/2"	1	21-2011DK
H HEAT SHIELD, 2019 TOYOTA	1	20-8651
I BOLT; M6 X 1.00 X 12MM, SS	6	07727
J WASHER; M6 SPLIT LOCK ZINC	6	1-3025
K WASHER; 6MM FLAT, SS	6	08269
L THREADED BOSS; 5/8"OD	2	081004
M BRACKET; "C", 69-8601, STL	2	070052
N EDGE TRIM; 3/4" BULB, TOP	1	102460
O SUPER GLUE, 3G DRIP PROOF	1	409

If you need any assistance please call 1-800-858-3333 to speak with a representative in our Customer Service Center before returning the product.

Read and understand these instructions **BEFORE** attempting to install this product. Failure to follow installation instructions and not using the provided hardware may damage the intake tube, throttle body and engine.

TO START:

1. Turn off the ignition and disconnect the negative battery cable.

NOTE: Disconnecting the negative battery cable erases pre-programmed electronic memories. Write down all memory settings before disconnecting the negative battery cable. Some radios will require an anti-theft code to be entered after the battery is reconnected. The anti-theft code is typically supplied with your owner's manual. In the event your vehicles anti-theft code cannot be recovered, contact an authorized dealership to obtain your vehicles anti-theft code.



2. Lift up and remove the decorative engine cover.



3. Disconnect the mass air sensor electrical connection and then unhook the wiring harness from the air filter housing.



4. Release the clamp and disconnect the crank case vent hose from the intake hose. Loosen the hose clamp that secures the intake hose to the throttle body and then disconnect the hose from the throttle body.



5. Release the upper air filter housing spring clamps and then remove the upper housing and intake hose from the vehicle.



6. Release the tab on the back side of the wiring harness and then remove the harness from the bracket.



7. Remove the three bolts that secure the lower air filter housing and then remove the lower housing from the fresh air intake and vehicle.

NOTE: AEM recommends that customers do not discard factory air intake.



8. Assemble the two heat shield mounting brackets as shown.



9. Install the heat shield mounting grommets as shown onto the factory air filter housing mounting location using the provided hardware.

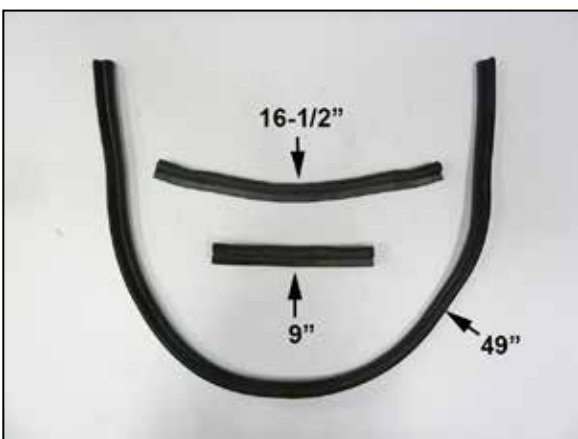

10. Cut the provided edge trim into sections of 9", 16.5" and 49" as shown.



11. Install the 9" edge trim onto the heat shield as shown.



12. Install the two remaining edge trims onto the heat shield as shown.



13. Set the heat shield onto the mounting brackets and around the fresh air intake and then secure with the provided hardware.



14. Install the provided coupler (5-252) onto the throttle body and secure with the provided hose clamps.



15. Remove the mass air sensor from the factory air filter housing and install it into the AEM® intake tube using the provided hardware.



16. Using a small amount of the provided superglue on the lip of the air straightener insert, install the air straightener into the tube as shown.

NOTE: install the so the blades are perpendicular to the sensor as shown.



17. Install the intake tube through the heat shield and into the coupler at the throttle body. Do not tighten at this time.



18. Connect the crank case vent to the AEM® intake tube and secure with the factory clamp.



19. Connect the mass air sensor electrical connection.



20. Install the air filter onto the intake tube and secure with the provided hose clamp. Adjust the intake tube for best fit and then secure with the provided hose clamps.



21. Reinstall the decorative engine cover.



Reassemble Vehicle

Position the inlet pipes for the best fitment. Be sure that the pipes or any other components do not contact any part of the vehicle. Tighten the rubber mount, all bolts, and hose clamps. Check for proper hood clearance. Re-adjust pipes if necessary and re-tighten them. Inspect the engine bay for any loose tools and check that all fasteners that were moved or removed are properly tightened. Reconnect negative battery terminal and start engine. Let the vehicle idle for 3 minutes. Perform a final inspection before driving the vehicle.

Service and Maintenance

AEM Induction Systems requires cleaning the intake system's air filter element every 100,000 miles. When used in dusty or off-road environments, our filters will require cleaning more often. We recommend that you visually inspect your filter once every 25,000 miles to determine if the screen is still visible. When the screen is no longer visible some place on the filter element, it is time to clean it. To clean, purchase our Synthetic air filter cleaner, part number 99-0624 and follow the easy instructions. Use window cleaner to clean your powder coated AEM® intake tube.

NOTE: DO NOT USE aluminum polish on powder coated AEM® intake tubes.

NOT LEGAL FOR SALE OR USE ON ANY POLLUTION CONTROLLED MOTOR VEHICLE IN CALIFORNIA OR STATES ADOPTING CALIFORNIA EMISSION PROCEDURES.

See aemintakes.com for CARB status on each part for a specific vehicle

AEM Air Intake System Warranty Policy

AEM® warrants that its intake systems will last for the life of your vehicle. AEM will not honor this warranty due to mechanical damage (i.e. improper installation or fitment), damage from misuse, accidents or flying debris. AEM will not warrant its powder coating if the finish has been cleaned with a hydrocarbon-based solvent. The powder coating should only be cleaned with a mild soap and water solution. Proof of purchase of both the vehicle and AEM intake system is required for redemption of a warranty claim.

This warranty is limited to the repair or replacement of the AEM part. In no event shall this warranty exceed the original purchase price of the AEM part nor shall AEM be responsible for special, incidental or consequential damages or cost incurred due to the failure of this product. Warranty claims to AEM must be transportation prepaid and accompanied with dated proof of purchase. This warranty applies only to the original purchaser of product and is nontransferable. Improper use or installation, use for racing, accident, abuse, unauthorized repairs or alterations voids this warranty. AEM disclaims any liability for consequential damages due to breach of any written or implied warranty on all products manufactured by AEM. Warranty returns will only be accepted by AEM when accompanied by a valid Return Merchandise Authorization (RMA) number. Credit for defective products will be issued pending inspection. Product must be received by AEM within 30 days of the date RMA is issued.

If you have a warranty issue, please call (800) 992-3000 and our customer service department will assist you. A proof of purchase is required for all AEM warranty claims.