



Equipped with AEM® Dryflow™ Filter
No Oil Required!

INSTALLATION INSTRUCTIONS

PART NUMBER

21-790C (GUN METAL GRAY FINISH)

2015-16

Honda

CR-V

2.4L

Not legal for sale or use on any pollution controlled motor vehicle in California or states adopting California emission procedures. See AEMIntakes.com for CARB status on each part for a specific vehicle.

ITEM NO.	PART NUMBER	DESCRIPTION	QTY.
1	21-2038DK	AIR FILTER	1
2	2-1567C	TUBE: 3.0" X 10.5", AL, 2015 HONDA CR-V 2.4L	1
3	20-8573	HEAT SHIELD, 2015 HONDA CR-V, TB/PC	1
4	084036	STEPPED HOSE	1
5	8-4036	EDGE TRIM, 36"	1
6	8-4013	EDGE TRIM, 13"	1
7	8-4008	EDGE TRIM, 8"	1
8	8-168	ADAPTER, PCV	1
9	08554K	1/2" BANDHOSE CLAMP, 2.15" - 3.00"	1
10	08601K	1/2" BANDHOSE CLAMP, 2.56" - 3.50"	2
11	1228596	MOUNT, RUBBER M6 X 3/4" TALL M/F	1
12	1-2038	BOLT; HEX/FLANGE M6-1 X 20	1
13	444.460.04	NUT; M6 HEX SERRATED	1

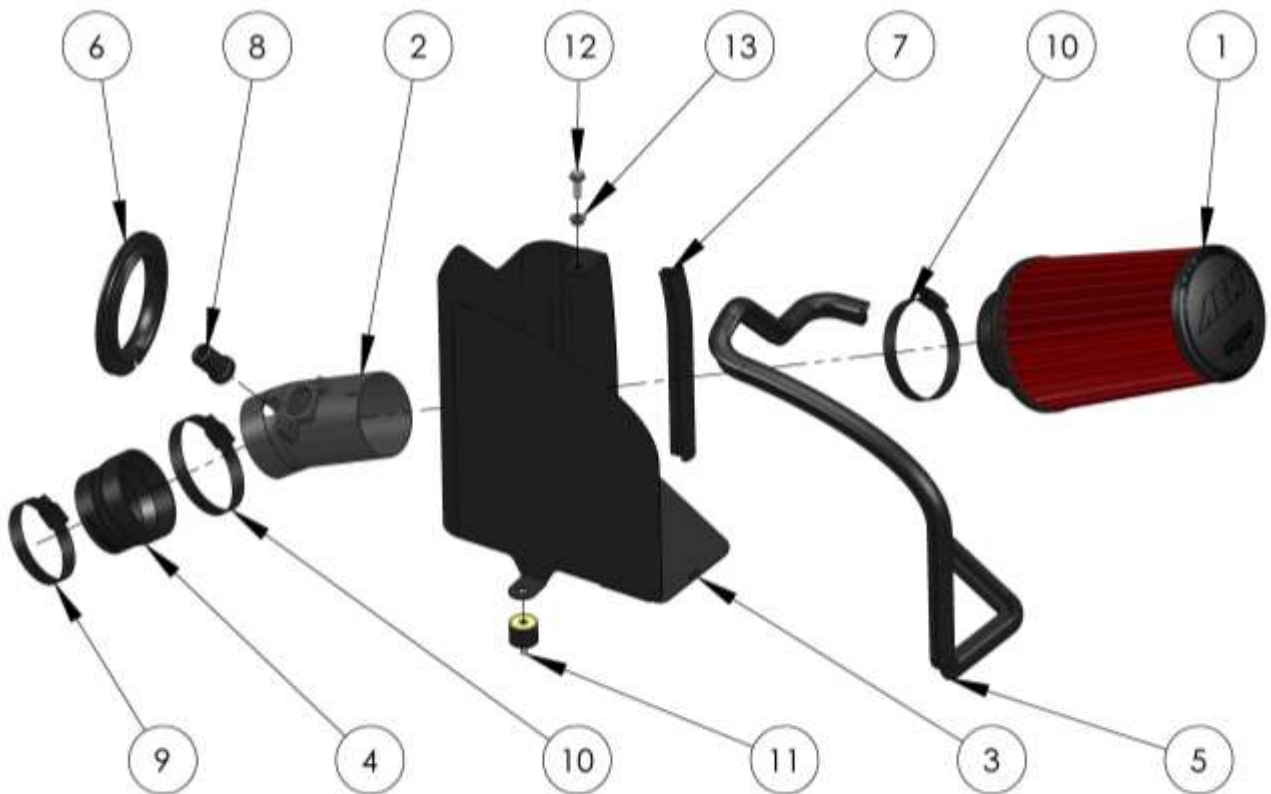

Read and understand these instructions **BEFORE** attempting to install this product. Failure to follow installation instructions and not using the provided hardware may damage the intake tube, throttle body and engine.

1. Preparing Vehicle

- a. Make sure vehicle is parked on level surface.
- b. Set the parking brake.
- c. If engine has run in the past two hours, let it cool down.
- d. Disconnect negative battery terminal.
- e. Do not discard stock components after removal of the factory system.
- f. Open the air intake kit package and refer to diagram on pg2 to make sure all parts are included.

Tools Needed:	Optional:
Screwdrivers	Small Torque Wrench
10mm Socket with Driver & Extensions	
10mm End Wrench	

2. Removal of stock system



a. Remove the upper bolt securing the factory air box.

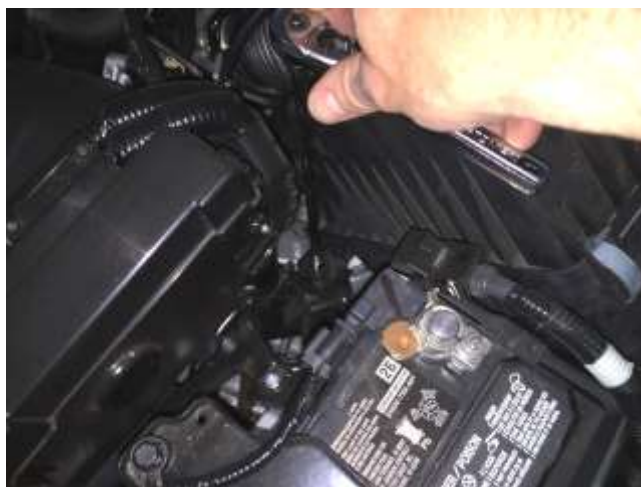

b. Remove the lower bolt securing the factory air box.



c. Disconnect the mass airflow sensor (MAS) wiring harness and disconnect the wiring retainer clip from the air box. Remove the sensor from the air box and set aside along with its screws to be reused in step 3f.



d. Disengage the spring clamp as shown and pull out the steel PCV line from the top of the factory coupler.



e. Use a Philips screwdriver or a 5.5mm socket to loosen the factory hose clamp on the factory coupler.



f. Unlatch the two factory air box clips.



g. Pull the factory coupler off of the throttle body and lift the upper air box assembly out of the vehicle.



h. Lift and pull the rear air box mount free of its rubber mount and remove the lower air box from the vehicle.



i. Remove the bolt securing the brake reservoir and set aside. It will be reused in step 3j.



j. Remove the rear air box rubber mount by prying it off of its post . Using soapy water as a lubricant may help. Set this part aside to be reused in step 3a.

3. Installation of AEM® intake system.

- a. When installing the intake system, do not completely tighten the hose clamps or mounting hardware until instructed to do so.



a. Install the edge trim pieces and the factory rear rubber mount onto the heat shield as shown.



b. Install the coupler and hose clamps onto the throttle body (TB) according to the diagram on pg2. Torque the TB hose clamp to 30 in-lbs. Leave the other clamp loose.



c. Lower the heat shield into place as shown and push the rear rubber mount down onto its post. Using soapy water as a lubricant may help. Mounting hardware will be added in later steps.



d. Install the filter onto the intake tube as shown and torque the clamp to 30 in-lbs. Rotate the filter such that the aluminum filter clip is located at the bottom when viewed in the orientation shown above.



e. Lower the filter and tube down through the corresponding opening in the heat shield and loosely install into the coupler.



f. Install the MAS using the factory screws. Consider putting a rag underneath tube to catch the screws in case they are dropped.



g. Install the rubber PCV adapter into the tube and install the steel PCV line. Reconnect the MAS wire harness and install wiring retainer clip into the heat shield slot.



h. Orient the filter and tube and tighten the last hose clamp to 30in-lbs.

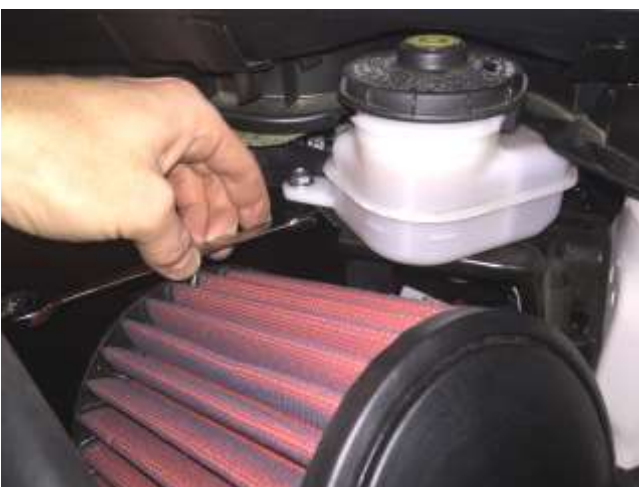

i. Use the provided bolt to re-mount the brake reservoir. Use the provided nut to secure the heat shield to the bottom of the bolt. Alternatively, the heat shield tab can be slid between the brake reservoir and the bracket.



j. Install the included rubber mount into the front air box mount threads. Use the bolt removed in step 2i to secure the heat shield to the rubber mount.



STOCK AIR BOX INSTALLED



AEM INTAKE INSTALLED

4. Reassemble Vehicle

- a. Position all kit components for best fitment. Ensure that no components contact any unintended part of the vehicle.
- b. Check for proper hood clearance. Re-adjust components if necessary and re-tighten them.
- c. Inspect the engine bay for any loose tools and ensure that all fasteners that were moved or removed are properly tightened.
- d. Reconnect negative battery terminal and start engine. Let the vehicle idle for 3 minutes. Perform a final inspection before driving the vehicle.

5. Service and Maintenance

- a. AEM Induction Systems requires cleaning the intake system's air filter element every 100,000 miles. When used in dusty or off-road environments, our filters will require cleaning more often. We recommend that you visually inspect your filter once every 25,000 miles to determine if the screen is still visible. When the screen is no longer visible some place on the filter element, it is time to clean it. To clean, purchase our Synthetic air filter cleaner, part number 1-1000 and follow the easy instructions.
- b. Use window cleaner to clean your powder coated AEM[®] intake tube.

NOTE: DO NOT USE aluminum polish on powder coated AEM[®] intake tubes.

For technical inquiries
e-mail us at
sales@aemintakes.com
or
call us at
800.992.3000

AEM Air Intake System Warranty Policy

AEM® warrants that its intake systems will last for the life of your vehicle. AEM® will not honor this warranty due to mechanical damage (i.e. improper installation or fitment), damage from misuse, accidents or flying debris. AEM® will not warrant its powder coating if the finish has been cleaned with a hydrocarbon-based solvent. The powder coating should only be cleaned with a mild soap and water solution. Proof of purchase of both the vehicle and AEM® intake system is required for redemption of a warranty claim.

This warranty is limited to the repair or replacement of the AEM® part. In no event shall this warranty exceed the original purchase price of the AEM® part nor shall AEM® be responsible for special, incidental or consequential damages or cost incurred due to the failure of this product. Warranty claims to AEM® must be transportation prepaid and accompanied with dated proof of purchase. This warranty applies only to the original purchaser of product and is nontransferable. Improper use or installation, use for racing, accident, abuse, unauthorized repairs or alterations voids this warranty. AEM® disclaims any liability for consequential damages due to breach of any written or implied warranty on all products manufactured by AEM®. Warranty returns will only be accepted by AEM® when accompanied by a valid Return Merchandise Authorization (RMA) number. Credit for defective products will be issued pending inspection. Product must be received by AEM® within 30 days of the date RMA is issued.

If you have a warranty issue, please call (800) 992-3000 and our customer service department will assist you. A proof of purchase is required for all AEM® warranty claims.

Not legal for sale or use on any pollution controlled motor vehicle in California or states adopting California emission procedures. See AEMIntakes.com for CARB status on each part for a specific vehicle.