



Equipped with AEM® Dryflow™ Filter
No Oil Required!

INSTALLATION INSTRUCTIONS

PART NUMBER

21-786C (GUN METAL GRAY FINISH)

2016

Mazda

MX-5

2.0L

Not legal for sale or use on any pollution controlled motor vehicle in California or states adopting California emission procedures. See AEMIntakes.com for CARB status on each part for a specific vehicle.

ITEM NO.	PART NUMBER	DESCRIPTION	QTY.
1	21-2157D	ELEMENT PARTS KIT 2-3/4"FLG, 5-1/2"B, 4-3/4T	1
2	2-1574	HEAT SHIELD RESERVIOR ASSY, 2016 MAZDA	1
3	2-1564C	INTAKE TUBE; 2.75"OD X 12", 21-786, GUNMET-	1
4	084014	HOSE; 2-3/4" TO 2-5/8" ID X 2" L TPRD REIN-	1
5	102470	EDGE TRIM; 3/4 BULB, TOP LOC, 57"L	1
6	08560K	HOSE CLAMP; #44, BLACK ZINC PLATED	3
7	1228559	MOUNT, RUBBER 1" X 8MM MALE/FEM	3
8	AEM-1-2046	BOLT; BTN HD M8-1.25 X 10MM	3

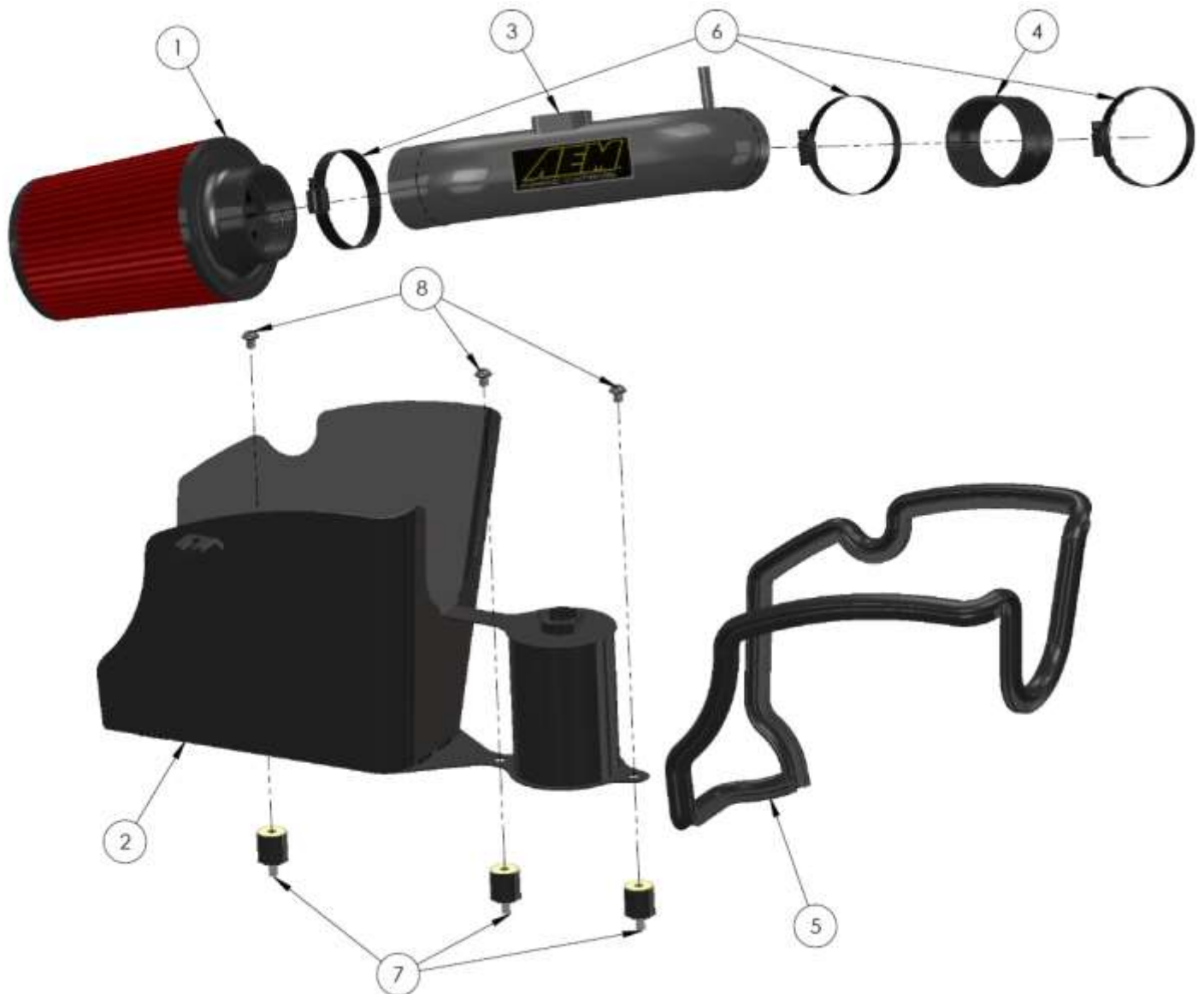

Read and understand these instructions **BEFORE** attempting to install this product. Failure to follow installation instructions and not using the provided hardware may damage the intake tube, throttle body and engine. If you need any assistance please call 1-800-858-3333 to speak with a representative in our Customer Service Center before returning the product.

1. Preparing Vehicle

- a. Make sure vehicle is parked on level surface.
- b. Set the parking brake.
- c. If engine has run in the past two hours, let it cool down.
- d. Disconnect negative battery terminal.
- e. Do not discard stock components after removal of the factory system.
- f. Open the air intake kit package and make sure all parts are included.

Tools Needed:	Optional:
Screwdriver	Small Torque Wrench
10mm Socket	
8mm Socket	
Socket Driver	
Side Cutters	

2. Removal of stock system



a. Loosen and remove the M6 bolt that secures the stock air box to the engine compartment.



b. Loosen the hose clamp that secures the factory air intake tube to the throttle body and disconnect the vent hose from the intake tube.



c. Loosen and remove the 2 screws that secure the MAF (Mass Air Flow) sensor to the factory air box then carefully remove the sensor and set aside.



d. Remove the cap from the coolant overflow tank and carefully remove the tank from the engine compartment. **Note: Do not drain the coolant from the tank at this time.**



e. Unclip the wiring harness from the factory air box then pull up and remove the air box from the engine compartment.



f. Remove the metal wiring harness bracket and the plastic air box bracket from the engine compartment. These will not be reinstalled. **AEM recommends that you do not discard your factory equipment and components.**

3. Installation of AEM[®] intake system.

- a. When installing the intake system, do not completely tighten the hose clamps or mounting hardware until instructed to do so.



a. Install the supplied rubber isolator mounts into the engine compartment as shown.



b. Install the supplied rubber edge trim onto the AEM heat shield assembly as shown.



c. Install the complete heat shield assembly into the engine compartment as shown and secure with supplied hardware.



d. Transfer the coolant from the factory tank into the AEM reservoir and seal with factory cap.



e. Install the AEM intake tube along with the supplied hose coupler and clamps onto the throttle body as shown, do not fully tighten at this time.



f. Install the MAF sensor removed in step 2c onto the AEM intake tube with supplied hardware and attach the vent hose.



g. Install the AEM air filter onto the AEM intake tube.



STOCK INTAKE INSTALLED



AEM INTAKE INSTALLED

4. Reassemble Vehicle

- a. Position all kit components for best fitment. Ensure that no components contact any unintended part of the vehicle.
- b. Check for proper hood clearance. Re-adjust components if necessary and re-tighten them.
- c. Inspect the engine bay for any loose tools and ensure that all fasteners that were moved or removed are properly tightened.
- d. Reconnect negative battery terminal and start engine. Let the vehicle idle for 3 minutes. Perform a final inspection before driving the vehicle.

5. Service and Maintenance

- a. AEM Induction Systems requires cleaning the intake system's air filter element every 100,000 miles. When used in dusty or off-road environments, our filters will require cleaning more often. We recommend that you visually inspect your filter once every 25,000 miles to determine if the screen is still visible. When the screen is no longer visible some place on the filter element, it is time to clean it. To clean, purchase our Synthetic air filter cleaner, part number 1-1000 and follow the easy instructions.
- b. Use window cleaner to clean your powder coated AEM[®] intake tube.

NOTE: DO NOT USE aluminum polish on powder coated AEM[®] intake tubes.

For technical inquiries
e-mail us at
sales@aemintakes.com
or
call us at
800.992.3000

AEM Air Intake System Warranty Policy

AEM® warrants that its intake systems will last for the life of your vehicle. AEM® will not honor this warranty due to mechanical damage (i.e. improper installation or fitment), damage from misuse, accidents or flying debris. AEM® will not warrant its powder coating if the finish has been cleaned with a hydrocarbon-based solvent. The powder coating should only be cleaned with a mild soap and water solution. Proof of purchase of both the vehicle and AEM® intake system is required for redemption of a warranty claim.

This warranty is limited to the repair or replacement of the AEM® part. In no event shall this warranty exceed the original purchase price of the AEM® part nor shall AEM® be responsible for special, incidental or consequential damages or cost incurred due to the failure of this product. Warranty claims to AEM® must be transportation prepaid and accompanied with dated proof of purchase. This warranty applies only to the original purchaser of product and is nontransferable. Improper use or installation, use for racing, accident, abuse, unauthorized repairs or alterations voids this warranty. AEM® disclaims any liability for consequential damages due to breach of any written or implied warranty on all products manufactured by AEM®. Warranty returns will only be accepted by AEM® when accompanied by a valid Return Merchandise Authorization (RMA) number. Credit for defective products will be issued pending inspection. Product must be received by AEM® within 30 days of the date RMA is issued.

If you have a warranty issue, please call (800) 992-3000 and our customer service department will assist you. A proof of purchase is required for all AEM® warranty claims.

Not legal for sale or use on any pollution controlled motor vehicle in California or states adopting California emission procedures. See AEMIntakes.com for CARB status on each part for a specific vehicle.