



advanced FLOW engineering

Instruction Manual

P/N: 77-44014

SCORCHER HD POWER MODULE

Make: Chevrolet	Model: Silverado 1500	Year: 2020-2021	Engine: L6-3.0L (td)
Make: GMC	Model: Sierra 1500	Year: 2020-2021	Engine: L6-3.0L (td)
Make: Cadillac	Model: Escalade	Year: 2021	Engine: L6-3.0L (td)
Make: Chevrolet	Model: Suburban	Year: 2021	Engine: L6-3.0L (td)
Make: Chevrolet	Model: Tahoe	Year: 2021	Engine: L6-3.0L (td)
Make: GMC	Model: Yukon	Year: 2021	Engine: L6-3.0L (td)
Make: GMC	Model: Yukon XL	Year: 2021	Engine: L6-3.0L (td)



THIS IS A HIGH-PERFORMANCE PRODUCT: Do not use this product until you have carefully read the following agreement and installation instruction. This sets forth the terms and conditions for the use of this product. The installation of this product indicates that the BUYER has read and understands this agreement and accepts its terms and conditions.

DISCLAIMER OF WARRANTY AND LIMITATION OF LIABILITY: Advanced FLOW Engineering, Inc. (also known as aFe or aFe POWER) and its successors, distributors, jobbers, and dealers (hereafter “SELLER”) shall in no way be responsible for the product’s improper use and service. It is the installer’s responsibility to check for proper installation and if in doubt, contact the manufacturer. The SELLER assumes no liability regarding the improper installation or misapplication of its products. BUYER acknowledges it has had the opportunity to fully inspect the product. Accordingly, BUYER acknowledges that the product is being sold in “AS IS/WHERE IS” condition. SELLER shall not be held liable for special, indirect, incidental or consequential damages of any nature with respect to the products (including, without limitation, lost profits, lost sales, loss of production, property damage, personal injury or loss or damage resulting from interruption or failure in operation of the products) and BUYER hereby expressly waives and disclaims all such liability claims. The BUYER acknowledges and agrees that the disclaimer of liability contained herein is a material term of the sale of the product and, to the fullest extent permitted by law, BUYER shall defend, indemnify and hold SELLER harmless from any and all claims, demands, causes of action, controversies, liabilities, fines, losses, costs and expenses (including, but not limited to attorneys’ fees, expert witness expenses and litigation expenses) arising from or related to SELLER’s products.

Before proceeding with the installation:

- Please read the entire instruction manual before proceeding.
- Ensure all components listed are present.
- If you are missing any of the components, call customer support at 951-493-7185.
- Ensure you have all necessary tools before proceeding. Do not attempt to work on your vehicle when the engine is hot.

Emission Disclaimer: This product is not currently CARB exempt and is not available for purchase in California or for use on any vehicle registered with the California Department of Motor Vehicles.



Label	Qty.	Description	Part Number
A	1	Module	R77-44014
B	1	LED Switch	05-70029
C	2	Velcro (2" Inches)	05-01244
D	5	Cable Ties	05-60167





SLEEP MODE

Figure A

Refer to Figure A for Step 1

Step 1: Before installing your aFe POWER module, you will have to place your vehicle's ECU in sleep mode.

In order to do this, you will need to do the following:

- If the engine is cold: open the hood, close the doors, lock the car and wait 30 seconds.
- If the engine is warm: open the hood, close the doors, lock the car and wait 20 minutes.
- If the engine is warm and you can't wait 20 minutes: disconnect the battery.



DO NOT OPEN VEHICLE DOORS WHILE SENSORS ARE DISCONNECTED OR BEFORE CONNECTING THE SCORCHER BLUE MODULE. DOING SO WILL TRIGGER A CHECK ENGINE LIGHT.



Refer to Figure B for Steps 2-3

Step 2: Remove the engine cover by removing the oil cap and the 10mm bolt.

Step 3: Re-install the oil cap to make sure that small parts cannot fall in while installing the Scorcher HD Power Module.

**Figure C****Refer to Figure C for Steps 4-6**

Step 4: Locate the Fuel Pressure Sensor. It is underneath the intercooler pipe.

Step 5: Disconnect the Fuel Pressure Sensor by pulling back on the locking tab and pressing down on the clip while sliding the connector out.

Step 6: Locate the Fuel Pressure Sensor Harness on the aFe POWER harness. Plug the female connector of the aFe POWER harness into the Fuel Pressure Sensor, then take the male connector of the aFe POWER harness and connect to the female connector of the engine harness.



Make sure that the connections are fully engaged. Usually, connectors make a snapping sound when fully engaged.

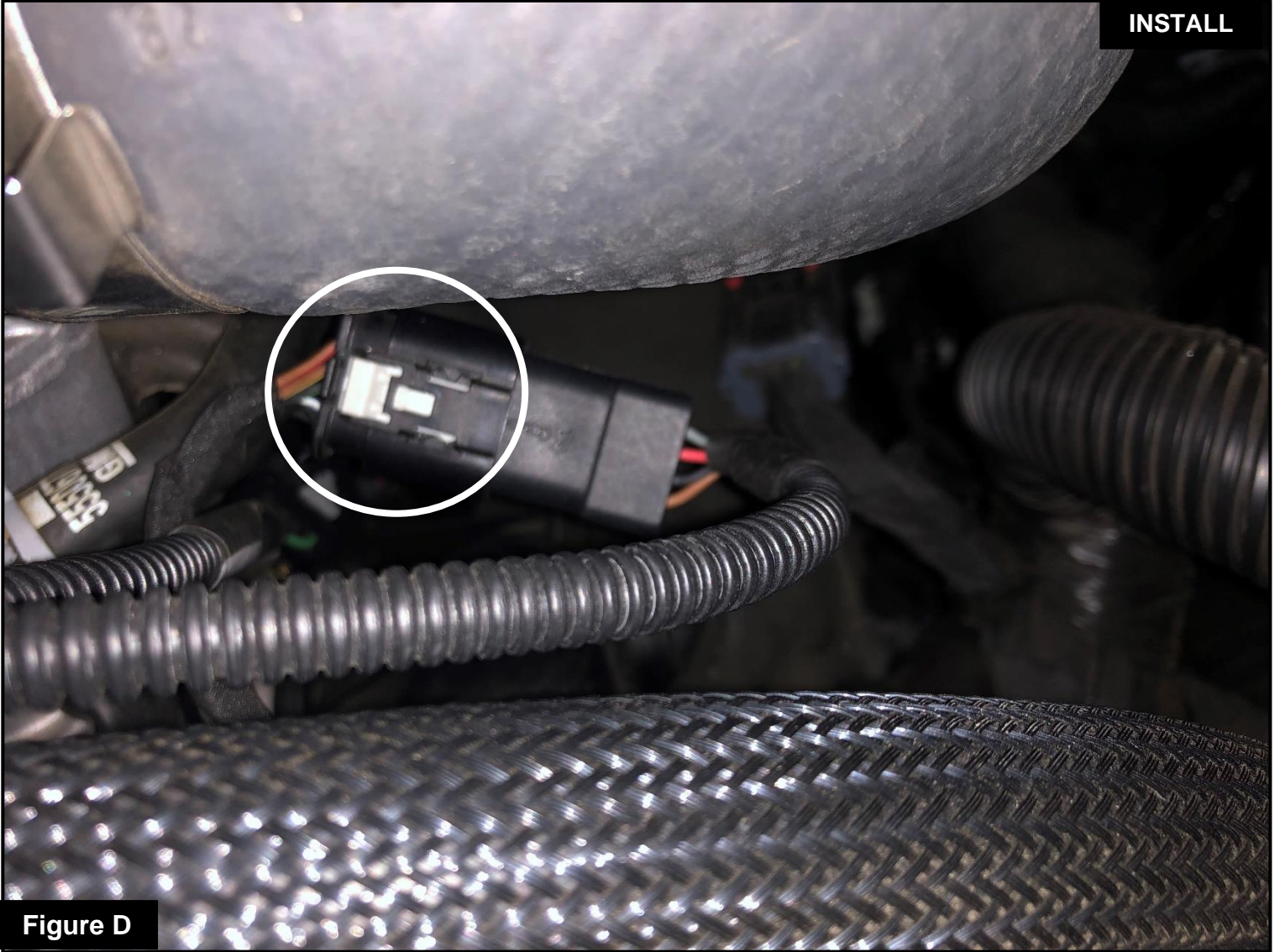

Figure D

Refer to Figure D for Step 7

Step 7: Check with the picture and make sure that both the male and female sides of the aFe POWER harness is plugged in and the locking tabs are slid back into place.



Figure E

Refer to Figure E for Steps 8-11

Step 8: Mount the Scorch HD module on top of the fuse box using the included Velcro.

Step 9: Use the included zip ties to secure wires away from moving parts and any components that will get hot when the engine is running.

Step 10: Remove the oil filler cap in order to reinstall the engine cover.

Step 11: Re-install the engine cover along with the oil cap and the 10mm bolt.

Note: The doors of the vehicle can now be opened to proceed with the installation of the LED switch.

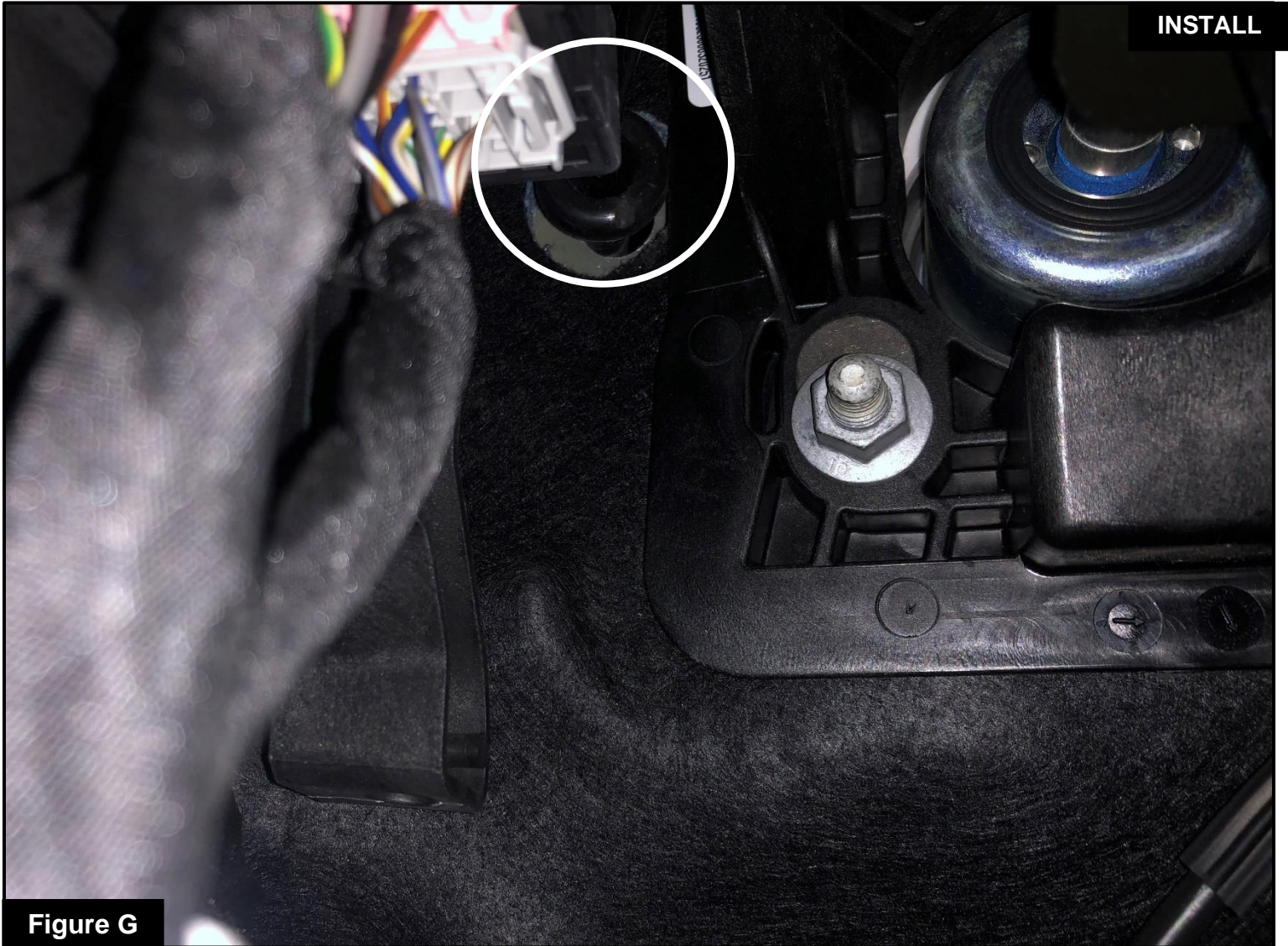

Figure F

Refer to Figure F for Steps 12-13

Step 12: Carefully route the switch behind the steering wheel cover

Step 13: Mount the switch on an open, flat surface using the included double-sided tape.

**Figure G****Refer to Figure G for Steps 14-16**

Step 14: Locate the grommet for the hood release cable inside of the cabin's driver side footwell and slightly pull it to the side in order to route the LED switch.

Step 15: Route the connector for the LED switch out to the engine bay using this hole.

Step 16: Connect the LED switch to the aFe POWER harness in the engine compartment.

The installation of the module itself is now complete. Keep reading the installation instruction to learn how to use all of its features.



Figure H

Refer to Figure H (LED Switch)

When turning on the vehicle, each LED will flash, and it will stop at its last setting. The LED on the switch represents the different level of power.

- Green LED: Stock
- Yellow LED: Sport
- Orange LED: Sport+
- Red LED: Race

Use the grey button to select the desired setting. Power adjustments can be done at any time while the unit is on. Thank you for choosing aFe POWER.



Page left blank intentionally.



Page left blank intentionally.



Momentum HD Cold Air Intake



P/N 50-70064T

Pro GUARD HD Fuel Filter



P/N: 44-FF023

Pro GUARD HD Oil Filter



P/N: 44-LF047

Sprint Booster



P/N: 77-14009

Blue Squeeze Restore Kit



P/N: 90-50501

Magnum FLOW Pro 5R Air Filter



P/N: 30-10292

aFe POWER Diesel Frame

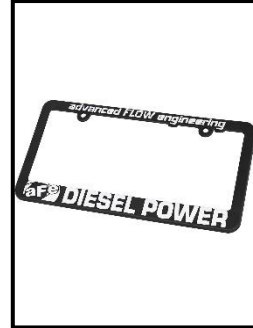

P/N: 40-10204

Rear Differential Cover



P/N: 46-71140B

To purchase any of the items above, view airflow charts, dyno graphs, photos, and video; please go to aFepower.com



Warranty

General Terms:

- aFe warrants their products to be free from manufacturer's defects due to workmanship and material.
- This warranty applies only to the original purchaser of the product and is non-transferrable.
- Proof of purchase of the aFe product is required for all warranty claims.
- Warranty is valid provided aFe instructions for installation and/or cleaning were properly followed.
- Proper maintenance with regular inspections of product is required to insure warranty coverage.
- Damage due to improper installation, abuse, unauthorized repair or alteration is not warranted.
- Incidental or consequential damages or cost, including installation and removal of part, incurred due to failure of aFe product is not covered under this warranty.
- All warranty is limited to the repair and/or replacement of the aFe part. To request Return Goods Authorization ("RGA"), email RGA@afepower.com or call (951)493-7100. Upon receipt of the RGA, you must return the product to the address provided in the RGA, freight prepaid and accompanied with a dated proof of purchase and the RGA. Upon receipt of the defective product and upon verification of proof of purchase, aFe will either repair or replace the defective product within a reasonable time, not to exceed thirty days.

Product Category	P/N Prefix	Warranty duration
Direct OE Replacement Filters	10, 11, 30, 31, 71, 73	Life of the vehicle
Racing Filters	18	1 year
Universal	20, 21, 23, 24, 72, TF	2 years
Air Intake Systems	50, 51, 53, 54, 55, 56, 57, 58, 75, TR, TA, TL, TM	2 years
Exhaust Systems	49	2 years
Intercoolers & Intercooler Tubes	46-2	2 years
Intake Manifolds	46-1	2 years
Differential Cover	46-7	Life of the vehicle
Exhaust Manifolds	46	2 years
Throttle Body Spacers	46-3	2 years
Turbochargers	46-6	2 years*
Fluid Filters	44	90 days
Pre-Filters	28	2 years
Heavy Duty OE Replacement	70	2 years
PowerSports OE Replacement	81, 87	2 years
Tuners	77	1 year

No other warranty expressed or implied applies nor is any person or advanced FLOW engineering authorized to assume any other warranty. Some States do not allow the exclusion or limitation of incidental or consequential damages or do not allow limitations on how long an implied warranty lasts, so the above limitations or exclusions may not apply to you. This warranty gives you specific legal rights, and you may also have other rights which vary from State to State.

*See turbocharger warranty for more info



advanced FLOW engineering, inc.

252 Granite Street Corona, CA 92879
TEL: 951.493.7100 • TECH: 951.493.7185
E-Mail: Tech@aFepower.com

P/N: 06-81374



advanced FLOW engineering Momentum HD Cold Air Intake System

Instruction Manual P/N: 50-70064D / 50-70064T

Make: Chevrolet	Model: Silverado 1500	Year: 2020-2021	Engine: I6-3.0L
Make: Chevrolet	Model: Tahoe/Suburban	Year: 2021	Engine: I6-3.0L
Make: GMC	Model: Sierra 1500	Year: 2020-2021	Engine: I6-3.0L
Make: GMC	Model: Yukon/Yukon XL	Year: 2021	Engine: I6-3.0L
Make: Cadillac	Model: Escalade	Year: 2021	Engine: I6-3.0L



- Please read the entire instruction manual before proceeding.
- Ensure all components listed are present.
- For technical support please call 951-493-7185.
- Ensure you have all necessary tools before proceeding.
- Do not attempt to work on your vehicle when the engine is hot.
- Retain factory parts for future use.

Label	Qty.	Description	Part Number
A1	1	Air Filter (Pro 10R)	20-91147
A2	1	Air Filter (Pro DRY S)	21-91147
B	1	Tube	05-5070064B1
C	1	Housing	05-5070064B2
D	1	Coupling, Silicone Bellow: 104mm ID x 3"L	05-01565
E	2	Clamp, T-bolt (4-1/16" - 4-3/8")	03-50262
F	1	Clamp, T-bolt (8-5/16" - 8-5/8")	03-50267
G	1	Plug, Silicone	05-01429
H	2	Screw, Torx: M4x10mm	03-50490
I	2	Ties, Nylon Cable Push Mount	03-50492

Installation will require the following tools:

Panel clip remover, T15 & T20 Torx drivers, 7mm & 8mm nut driver, small flat-head screwdriver, 10mm & 11mm deep sockets and driver, 10mm & 13mm sockets and driver

Emissions Disclaimer: This product is not currently CARB exempt and is not available for purchase in California or for use on any vehicle registered with the California Department of Motor Vehicles.

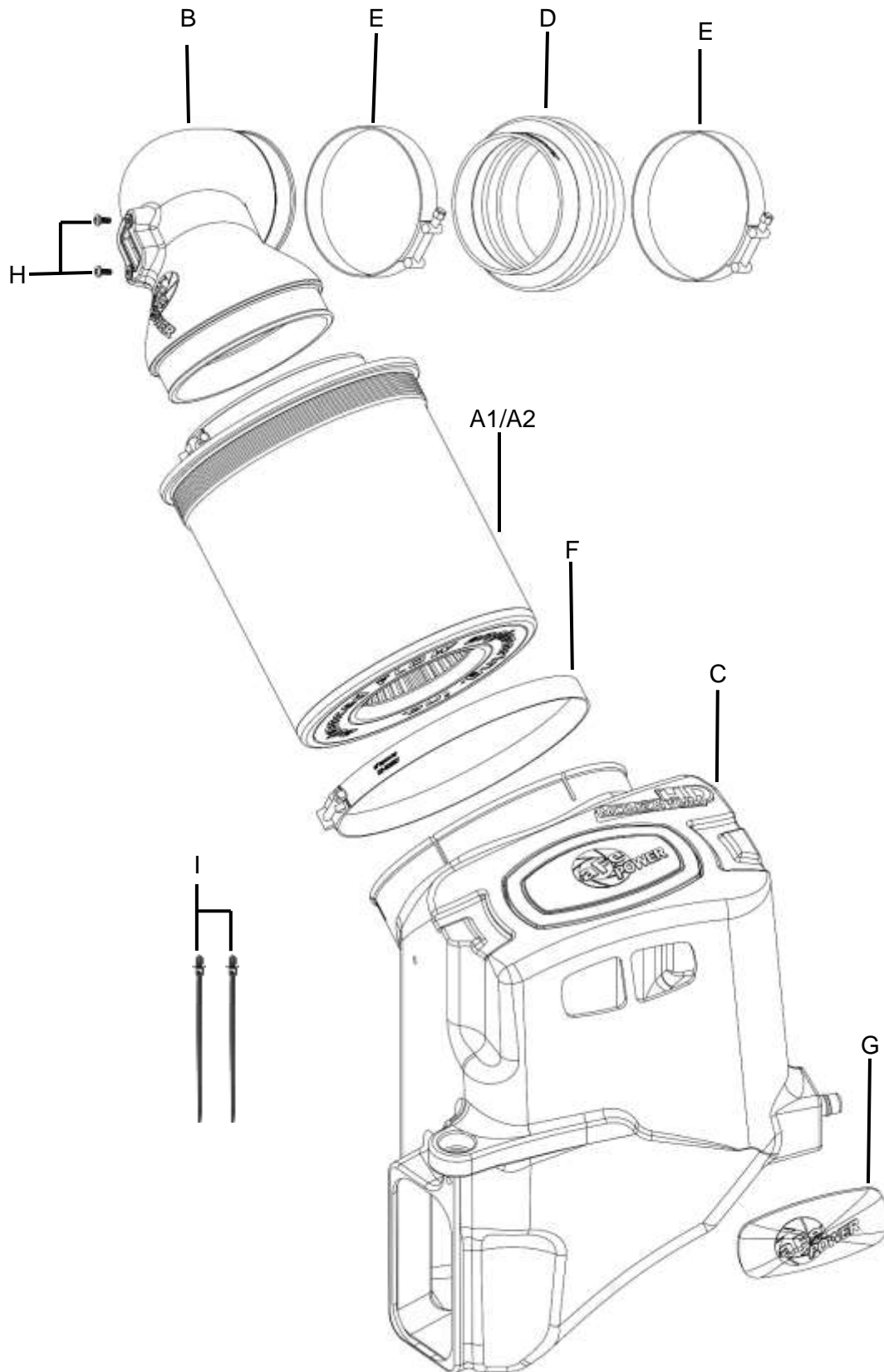



Figure A

Refer to Figure A for Steps 1-3

Step 1: Disconnect the MAF sensor (1).

Step 2: Using a 7mm nut driver, loosen the hose clamp (2) at the turbo inlet tube.

Step 3: Using an 8mm nut driver, loosen the three screws (3) securing the upper factory airbox lid. Remove the upper factory airbox lid with the intake hose as one piece.



Figure B

Refer to Figure B for Steps 4-5

Step 4: Using a T-15 Torx driver, remove the two screws (4) securing the hood latch and then slide it out to remove. Set the screws aside.

Step 5: Using a panel clip remover, remove all ten (x10) panel clips (5) holding the sight shield. Remove the shield and set it aside with the clips.

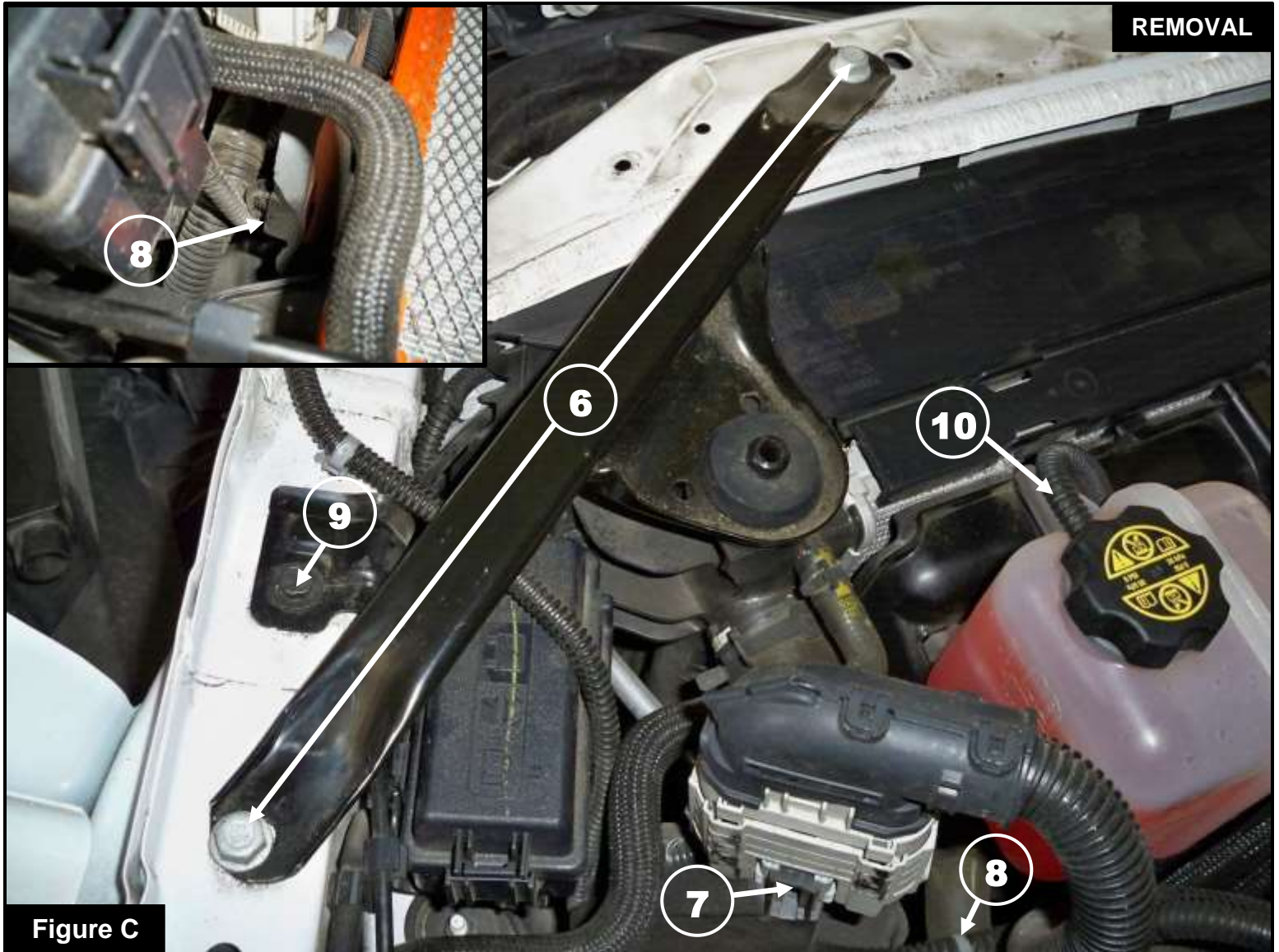

Figure C

Refer to Figure C for Steps 6-9

Step 6: Using a 13mm socket and driver, remove the two screws (6) holding the cross bar. Lift up the cross bar to remove and set aside with the screws.

Step 7: Using a small flat-head screwdriver, release the locking tab at the wiring harness connector (7) and unsnap the two (x2) harness ties (8).

Step 8: Using a 10mm socket and driver, remove the screw (9) holding the fuse block bracket and set it aside.

Step 9: Using a 10mm socket and driver, remove the screw (10) holding the coolant reservoir and set it aside.

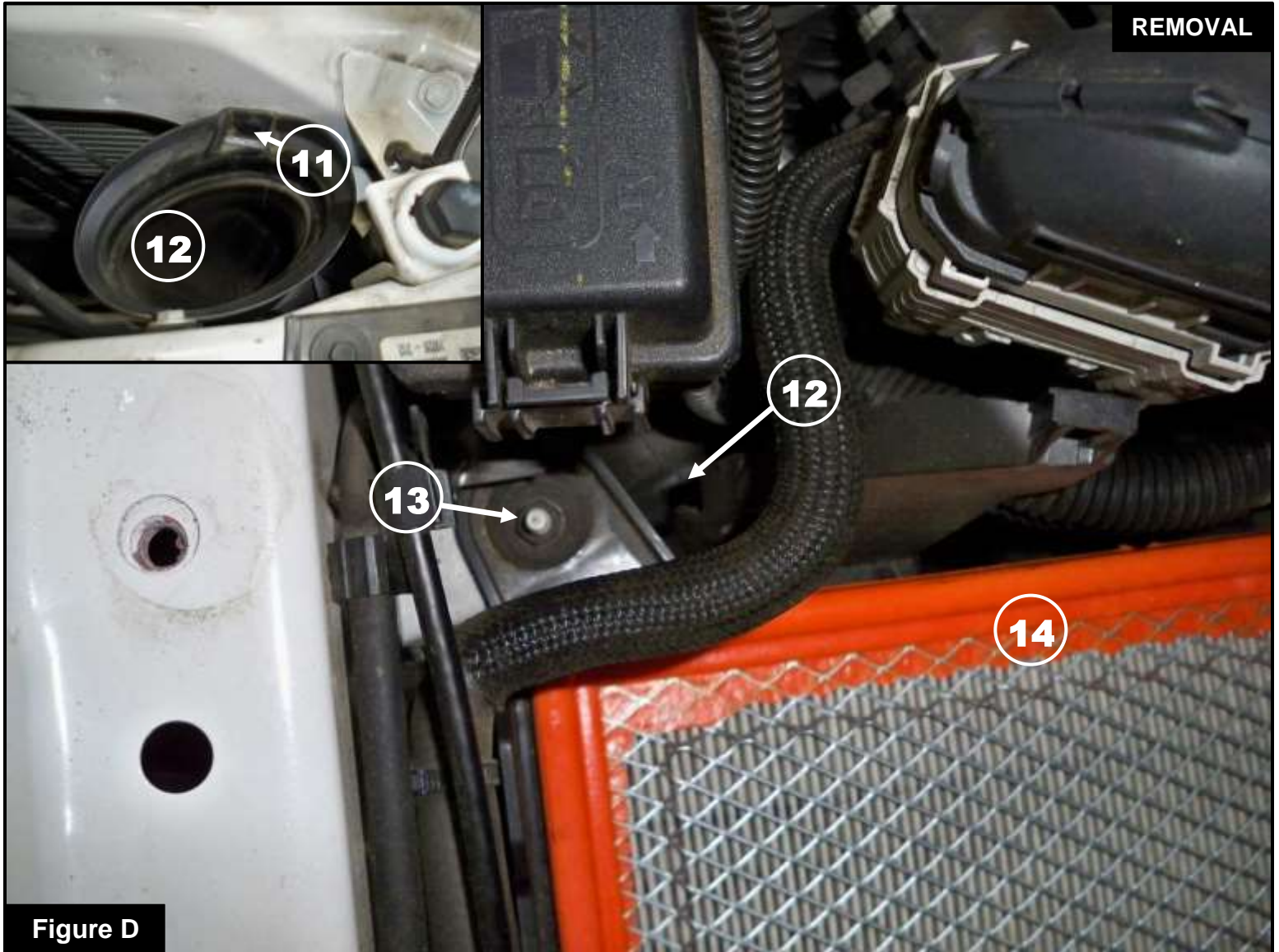

Refer to Figure D for Steps 10-13

Step 10: Using the clip remover, remove the clip (11) that's holding the air scoop and set aside.

Step 11: Pull the air scoop (12) out of the way from the factory airbox.

Step 12: Using a 10mm deep socket and driver, remove the nut (13) that secures the factory airbox to the vehicle and set aside.

Step 13: Remove the air filter (14).



Figure E

Refer to Figure E for Step 14

Step 14: Remove the factory airbox by pulling up out of the securing stud and towards the front of the vehicle. Two pins with grommets (15) will have to come out of the holding bracket and a clear path is needed so that the air scoop is not in the way of the factory airbox. The coolant reservoir, fuse block and wiring harness will have to move for clearance.

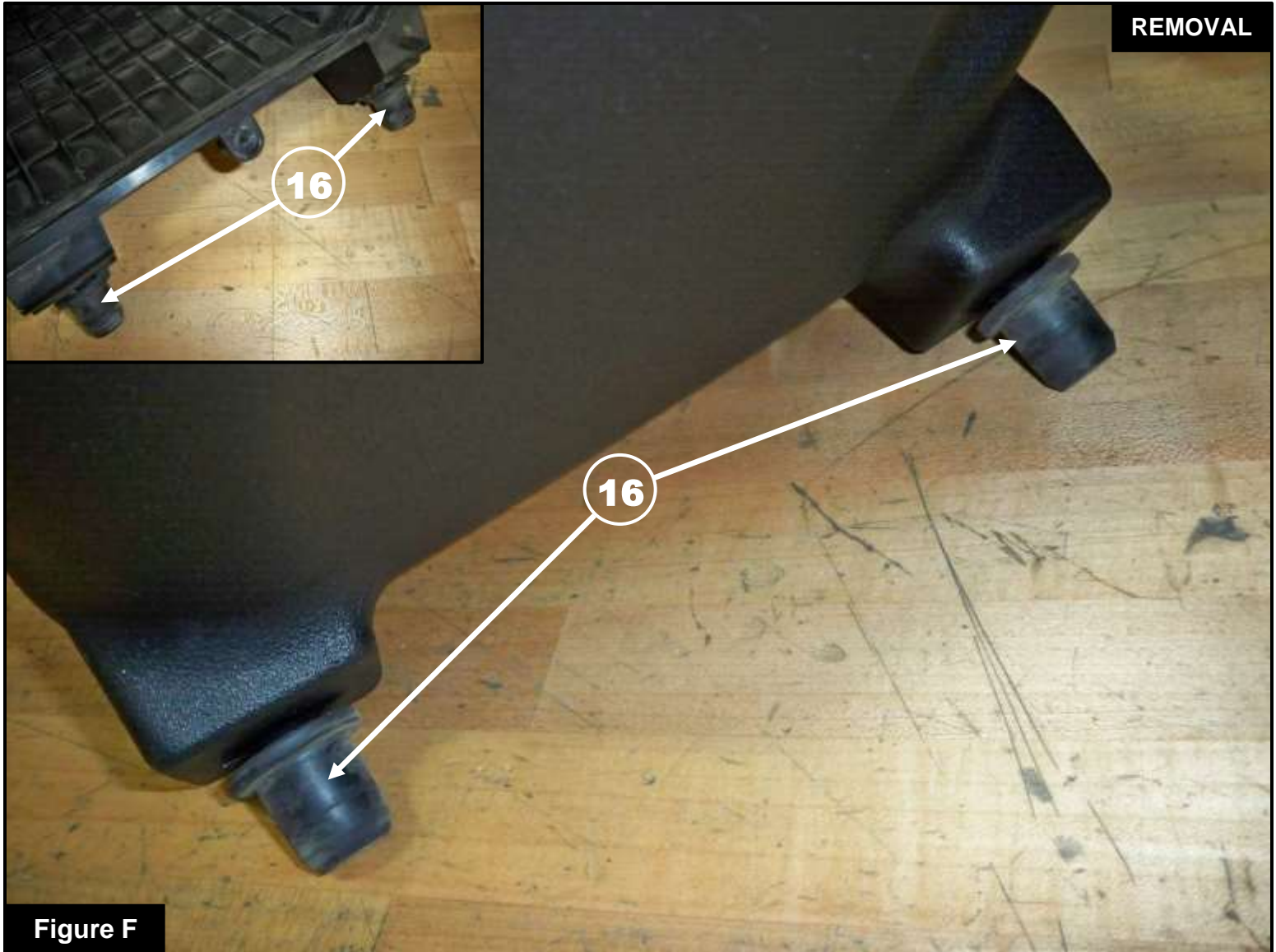

Refer to Figure F for Step 15

Step 15: Remove the two grommets (16) from the factory airbox pins and install them onto the aFe POWER housing.

**Figure G****Refer to Figure G for Step 16**

Step 16: Remove the front metal insert and grommet (17) from the factory airbox and install them into the aFe POWER housing.

**Figure H****Refer to Figure H for Step 17**

Step 17: Using a T20 Torx driver, remove the MAF sensor ⑮ from the factory airbox and install it on the aFe POWER intake tube using the supplied M4 screws.

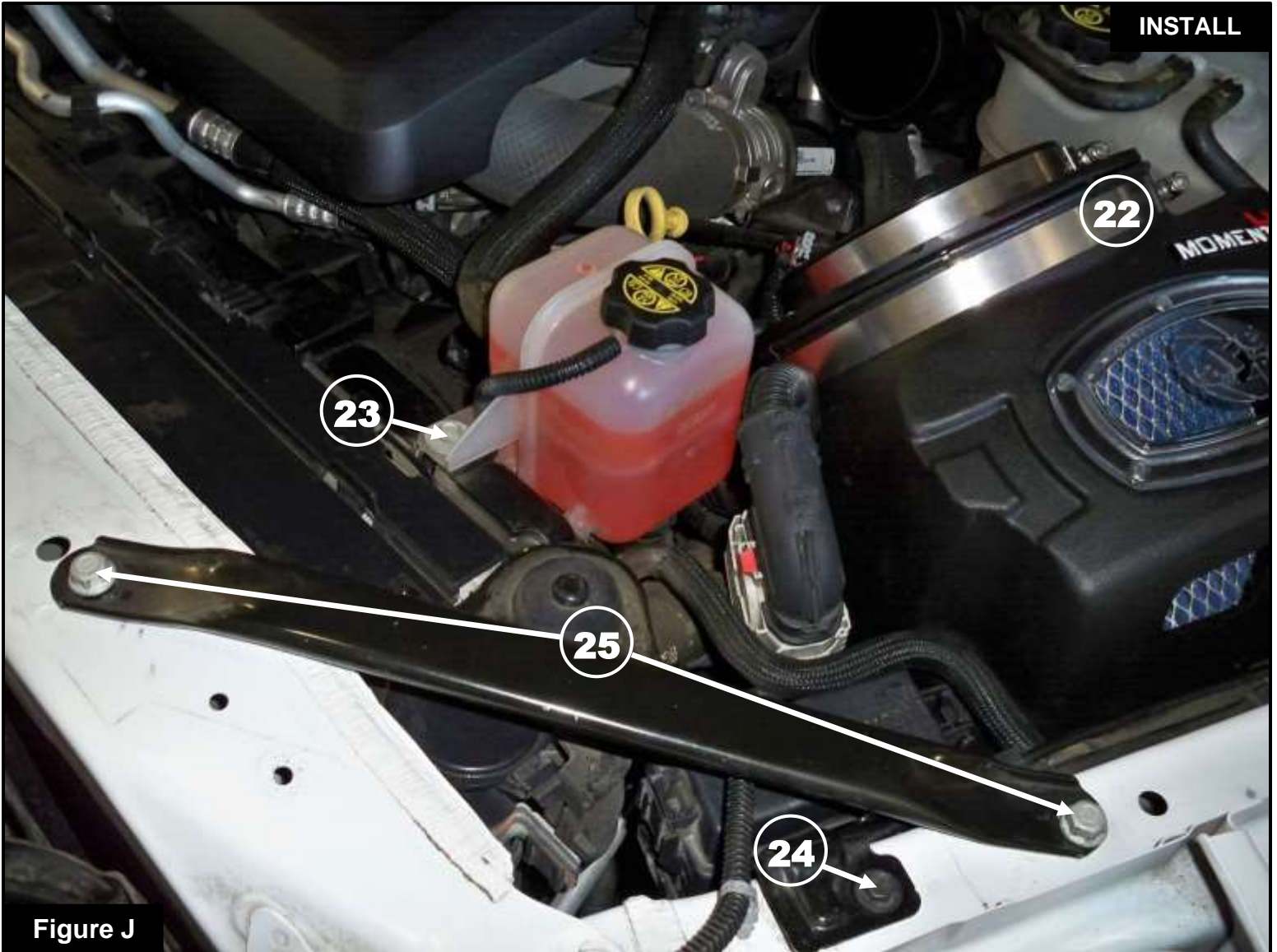

Figure I

Refer to Figure I for Steps 18-19

Step 18: Install the aFe POWER housing into the vehicle. Make sure the two pin grommets are secure inside the holding bracket. Reinstall and tighten the nut (19) removed in Step 12.

Step 19: Slide the air scoop (20) inside the front opening of the aFe POWER housing. Align the air scoop and reinstall the clip (21) removed in Step 10.

**Figure J****Refer to Figure J for Steps 20-24**

Step 20: Slide the large T-Bolt clamp (22) over the air filter opening on the aFe POWER housing.

Step 21: Slide the aFe POWER filter with clamp into the aFe POWER housing. Do not tighten the clamps.

Step 22: Install and secure the coolant reservoir with the screw (23) removed on Step 9.

Step 23: Install and secure the fuse block bracket with the screw (24) removed on Step 8.

Step 24: Install the cross bar with the two screws (25) removed in Step 6 and tighten them.

**Figure K****Refer to Figure K for Steps 25-26**

Step 25: Install the sight shield (26) with all ten clips removed in Step 5.

Step 26: Install the hood latch (27) with the two screws removed in Step 4 and tighten them.

**Figure L****Refer to Figure L for Step 27**

Step 27: Place the supplied aFe POWER coupling (28) and one of the T-Bolt clamp (29) over the turbo inlet tube and tighten the clamp using a 11mm deep socket and driver. Place the other T-Bolt clamp (30) onto the coupling but do not tighten this clamp.



Figure M

Refer to Figure M for Steps 28-29

Step 28: Install the aFe POWER intake tube into the vehicle. Slide the tube into the coupling first, then into the air filter.

Step 29: Align the tube and clamps correctly, then using a 11mm deep socket and driver tighten all the clamps.

**Figure N****Refer to Figure N for Steps 30-33**

Step 30: Reconnect the MAF sensor (31).

Step 31: Use the supplied captive tie to secure the wiring harness to the aFe POWER housing and snap the tie in the provided upper hole.

Step 32: Use the provided plug (32) to close the additional air inlet if you want to completely seal the housing. Best performance gain is obtained by having more air flow (no plug).

Step 33: Check all the components are tight and secure. Your installation is now complete. Thank you for choosing aFe POWER!

NOTE: Check all bolts, clamps, and connectors after 100-200 miles.

Pro DRY S Air Filter



P/N: 21-91147

Pro 10R Air Filter



P/N: 20-91147

Pro DRY S Restore Kit



P/N: 90-59999

Blue Squeeze Restore Kit



P/N: 90-50501

Pre-Filter



P/N: 28-10273

aFe Fender Cover



P/N: 40-10230

Pro GUARD Fuel Filter



P/N: 44-FF023

Pro GUARD HD Oil Filter



P/N: 44-LF047

Rear Differential Cover



P/N: 46-71140A

Sprint Booster V3



P/N 77-14009

Flashlight LED USB



P/N 40-10202

Magnetic Folding Flashlight



P/N 40-10229



To purchase any of the items above, view airflow charts, dyno graphs, photos, and video; please go to aFepower.com.

Warranty

General Terms:

- aFe warrants their products to be free from manufacturer’s defects due to workmanship and material.
- This warranty applies only to the original purchaser of the product and is non-transferrable.
- Proof of purchase of the aFe product is required for all warranty claims.
- Warranty is valid provided aFe instructions for installation and/or cleaning were properly followed.
- Proper maintenance with regular inspections of product is required to insure warranty coverage.
- Damage due to improper installation, abuse, unauthorized repair or alteration is not warranted.
- Incidental or consequential damages or cost, including installation and removal of part, incurred due to failure of aFe product is not covered under this warranty.
- All warranty is limited to the repair and/or replacement of the aFe part. To request Return Goods Authorization (“RGA”), email RGA@aFepower.com or call (951)493-7100. Upon receipt of the RGA, you must return the product to the address provided in the RGA, freight prepaid and accompanied with a dated proof of purchase and the RGA. Upon receipt of the defective product and upon verification of proof of purchase, aFe will either repair or replace the defective product within a reasonable time, not to exceed thirty days.

Product Category	P/N Prefix	Warranty duration
Direct OE Replacement Filters	10, 11, 30, 31, 71, 73	Life of the vehicle
Racing Filters	18	1 year
Universal	20, 21, 23, 24, 72, TF	2 years
Air Intake Systems	50, 51, 53, 54, 55, 56, 57, 58, 75, TR, TA, TL, TM	2 years
Exhaust Systems	49	2 years
Intercoolers & Intercooler Tubes	46-2	2 years
Intake Manifolds	46-1	2 years
Differential Cover	46-7	Life of the vehicle
Exhaust Manifolds	46	2 years
Throttle Body Spacers	46-3	2 years
Turbochargers	46-6	2 years*
Fluid Filters	44	90 days
Pre-Filters	28	2 years
Heavy Duty OE Replacement	70	2 years
PowerSports OE Replacement	81, 87	2 years
PowerSports Intake Systems	85	2 years

No other warranty expressed or implied applies nor is any person or advanced FLOW engineering authorized to assume any other warranty. Some States do not allow the exclusion or limitation of incidental or consequential damages or do not allow limitations on how long an implied warranty lasts, so the above limitations or exclusions may not apply to you. This warranty gives you specific legal rights, and you may also have other rights which vary from State to State.

*See turbocharger warranty for more info



advanced FLOW engineering, inc.

252 Granite Street Corona, CA 92879
TEL: 951.493.7100 • TECH: 951.493.7134
E-Mail: Tech@aFepower.com

P/N: 06-81382