



INSTALLATION INSTRUCTIONS

Cat-Back Exhaust

MAKE: Audi
MODEL: RS6 Avant
YEAR: 2020-2022
ENGINE: V8-4.0L (tt)

49-36448-B
 49-36448-C
 49-36448-P

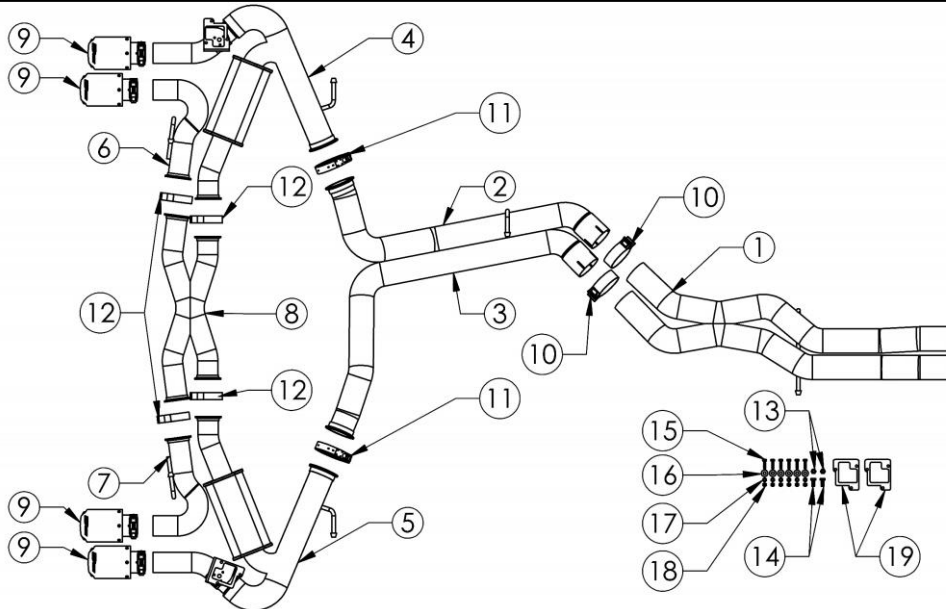

Item	Description	Part Number	Quantity
1	Front X-Pipe	05-245298	1
2	Driver Side Mid-Pipe	05-245299	1
3	Passenger Side Mid-Pipe	05-245374	1
4	Driver Side Outer Tailpipe	05-245301	1
5	Passenger Side Outer Tailpipe	05-245300	1
6	Driver Side Inner Tailpipe	05-245304	1
7	Passenger Side Inner Tailpipe	05-245303	1
8	Rear X-Pipe	05-245302	1
9	EXH Tip 2-1/2 In x 4 Out x 7L Bolt-On Blk	49T25404-B06	4
9	EXH Tip 2-1/2 In x 4 Out x 7L Bolt-On CF	49T25404-C07	4
9	EXH Tip 2-1/2 In x 4 Out x 7L Bolt-On Pol	49T25404-P06	4
10	Clamp, Band: 3"	05-41055	2
11	Clamp, V-Band 3"	05-41588	2
12	Clamp, V-Band 2-1/2"	05-410196	4
13	Nut, M8 x 1.25	03-50403	2
14	Bolt, M8 x 1.25 x 25mm	03-50442	2
15	Screw, Hex Head: M6 x 1 x 25	03-50114	6
16	Washer, Flat: M6	03-50070	6
17	Washer, Lock: M6	03-50071	6
18	Nut, Hex: M6 X 1, Gr 8.8	03-50059	6
19	Bracket, Audi RS6 Valve Motor Plate	05-46528	2

aFe POWER recommends professional installation on this product. Thoroughly inspect the aFe POWER exhaust system to make sure there is no damage from shipping (if damage is noted, immediately contact aFe POWER customer service). Allow time for your vehicle to cool down prior to installation. When working on your vehicle proceed with caution. Wear protective safety equipment; eye goggles and gloves to ensure a safe installation.

Install band clamps to proper torque specifications of 40-45 ft-lb.

Install V-band clamps with anti-seize lubricant and hand tighten only to torque specifications of 10-15 ft-lb.



INSTALLATION INSTRUCTIONS

MAKE: Audi
MODEL: RS6 Avant
YEAR: 2020-2022
ENGINE: V8-4.0L (tt)

Cat-Back Exhaust

49-36448-B

49-36448-C

49-36448-P

1. **(Read instructions prior to installation.)** It is recommended to not fully tighten the exhaust until it has been fully installed. Leave loose for adjustability.
2. Secure vehicle on jack stands (refer to your manual for specified jack stand positions).
3. For faster installation, spread out the parts of the exhaust alongside your vehicle as shown in the diagram above.
4. Secure the stock exhaust with jack/stands.
5. Remove Passenger and Driver Side under-floor panels. Retain Hardware for reinstallation.
6. Remove both center crossmembers. Retain Hardware for reinstallation.
7. Remove Driver Side and Passenger Side Rear Chassis Reinforcements off the vehicle. Retain Hardware for reinstallation.
8. Disconnect Exhaust Valve connector on both the Driver and Passenger Side.
9. Loosen the nuts on the O.E. Sleeve Clamps and slide the sleeve clamps towards the front of the vehicle.
10. Remove the (x5) O.E. Rubber Isolation Bracket Assemblies from the vehicle. These will be transferred over to the aFe Power Exhaust.
11. Remove the remaining hanger from the Rubber Isolation Mount.
12. Remove the O.E. Exhaust from the vehicle.
13. Remove O.E. Rubber Isolation Bracket Assembly from O.E Exhaust and install on to the aFe Power Front X-Pipe.
14. Install the aFe Power Front X-Pipe to the O.E. Front Pipes using the O.E. Sleeve Clamps. Tighten the O.E. Rubber Isolation Bracket Assembly onto the chassis together with the center crossmember.
15. Slide aFe Power Driver Side Mid-Pipe into the aFe Power X-Pipe and secure with provided 3" Band Clamp. Slide Hanger into Rubber Isolation Mount.
16. Slide aFe Power Passenger Side Mid-Pipe into the aFe Power X-Pipe and secure with provided 3" Band Clamp.
17. Using the provided (x2) Nuts and (x2) Bolts, tighten down the bracket that holds the aFe Power Passenger Side Mid-pipe and aFe Power Driver Side Mid-Pipe together.
18. Assemble the aFe Power Rear X-Pipe, aFe Power Driver/Passenger Outer Tailpipe, and aFe Power Driver/Passenger inner Tailpipe outside the vehicle using the supplied 2-1/2" V-Band Clamps.
19. Remove the (x4) O.E. Rubber Isolation Bracket Assemblies from the O.E. exhaust and install on to the assembled rear section of the aFe Power Exhaust.
20. Remove the exhaust valve motors from the O.E. exhaust and install on to the aFe Power Exhaust using the supplied hardware and the aFe Power Bracket.
21. Install the assembled aFe Power rear section to the aFe Power Driver/Passenger Side Mid-Pipes using the supplied 3" V-Band Clamps.
22. Tighten down the the O.E. Rubber Isolation Bracket Assemblies to the chassis.
23. Plug the exhaust valve connector into the exhaust valve motor.
24. Install aFe Power Exhaust Tips and adjust accordingly.
25. Reinstall Driver Side and Passenger Side Rear Chassis Reinforcements using the O.E. Hardware.
26. Reinstall remaining center cross member using the O.E. Hardware.
27. Ensure that all the components of the aFe POWER exhaust system are aligned and are at a safe clearance from all wires, hoses, brake lines, body parts, and tires.
28. Start from the front of the aFe exhaust system and evenly tighten all clamps and fasteners.
29. Start the vehicle and check for any leaks. If any leaks are found, determine cause and repair as necessary.
30. Remove vehicle from jacks stands.
31. It is recommended to re-tighten all clamps and hardware after 50-100 miles.



INSTALLATION INSTRUCTIONS

MAKE: Audi
MODEL: RS6 Avant
YEAR: 2020-2022
ENGINE: V8-4.0L (tt)

Cat-Back Exhaust

49-36448-B

49-36448-C

49-36448-P