



Equipped with AEM® Dryflow™ Filter
No Oil Required!

INSTALLATION INSTRUCTIONS

PART NUMBER

21-791C (GUN METAL GRAY FINISH)

2016

LEXUS

IS200T

2.0T

Not legal for sale or use on any pollution controlled motor vehicle in California or states adopting California emission procedures. See AEMIntakes.com for CARB status on each part for a specific vehicle.

| ITEM NO. | PART NUMBER | DESCRIPTION | QTY. |
|----------|-------------|--|------|
| 1 | 2-1568C | INTAKE TUBE; 3.25" X 23"L, 21-791; GUNMETAL GRAY | 1 |
| 2 | 21-2113DK | AIR FILTER; 3.25" X 7" DRYFLOW | 1 |
| 3 | 20-8574 | HEAT SHIELD, 21-791, 2016 LEXUS IS200T, TB/PC | 1 |
| 4 | 9-0378 | VENTURI; 3.075"OD X 2.975"ID X 3.25"L, PLASTIC | 1 |
| 5 | 08476 | HOSE; 2-1/2" TO 2-1/4" ID X 2" L TPRD REINFORCED | 1 |
| 6 | 9452 | 1/2" BNDHOSE CLAMP,2.90"-3.75" | 1 |
| 7 | 9436 | 1/2" BNDHOSE CLAMP,1.81"-2.75" | 2 |
| 8 | 8-4030 | EDGE TRIM, 30" | 1 |
| 9 | 8-4012 | EDGE TRIM, 12" | 1 |
| 10 | 102466 | EDGE TRIM; 1/16"GAP, 12"L | 1 |
| 11 | 1228598 | MOUNT, RUBBER 5/8" X 6MM | 1 |
| 12 | 08160 | WASHER; 1"D X 1/4 HOLE FENDER | 1 |
| 13 | 444.460.04 | NUT; M6 HEX SERRATED | 1 |
| 14 | 1-2038 | BOLT; HEX/FLANGE M6-1 X 20 | 1 |
| 15 | 07733 | BOLT; M4 - 0.07 8MM, A/H CAP, SS | 2 |

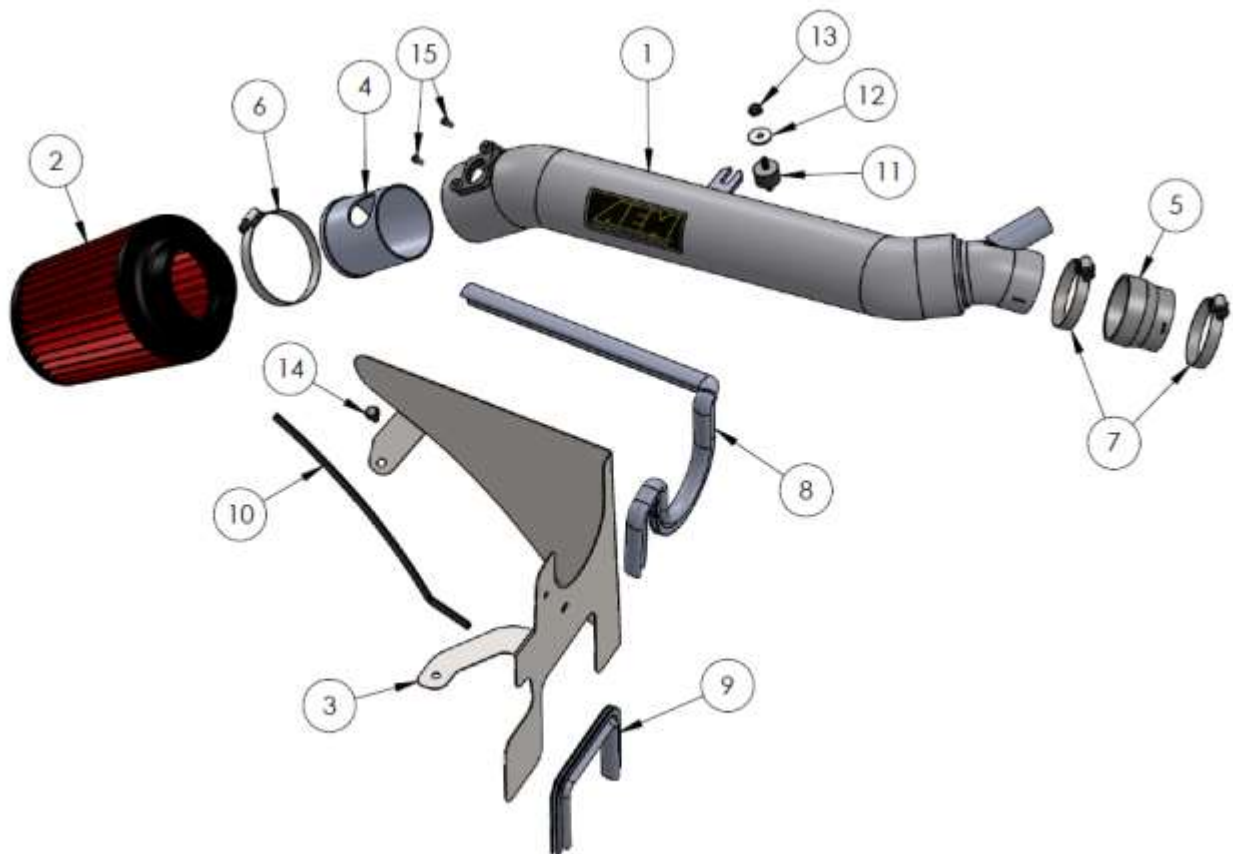

Read and understand these instructions **BEFORE** attempting to install this product. Failure to follow installation instructions and not using the provided hardware may damage the intake tube, throttle body and engine. If you need any assistance please call 1-800-858-3333 to speak with a representative in our Customer Service Center before returning the product.

| Tools Needed: | Optional: |
|---------------|---------------------|
| Screwdriver | Small Torque Wrench |
| 10mm Socket | |
| 8mm Socket | |
| Ratchet | |
| Pliers | |

1. Preparing Vehicle

- Make sure vehicle is parked on level surface.
- Set the parking brake.
- If engine has run in the past two hours, let it cool down.
- Disconnect negative battery terminal.
- Do not discard stock components after removal of the factory system.
- Open the air intake kit package and make sure all parts are included.

2. Removal of stock system

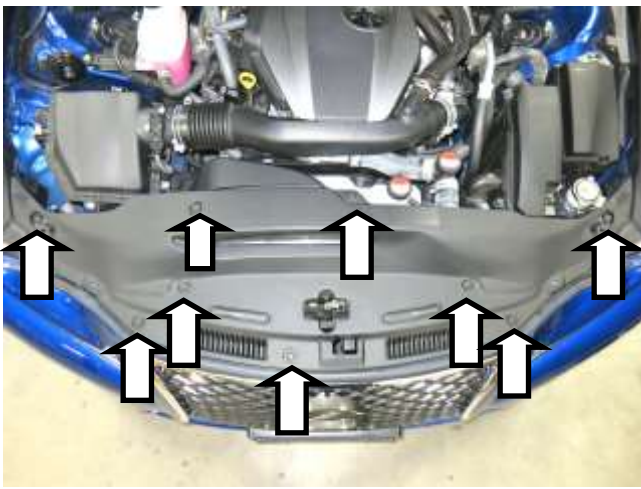

a. Remove the 9 push clips that hold the radiator shroud in place.



b. Carefully pull up on the engine cover and remove it.



c. Use pliers to relieve tension on the hose clamp and then pull the breather hose off of the stock intake tube port.



d. Remove the M6 bolt holding the intake tube to the engine.



e. Use a 10mm socket and ratchet, or a Phillips head screwdriver, to loosen the hose clamp holding the intake tube to the air box. Then, pull the intake tube off of the air box.



f. Loosen the hose clamp holding the intake tube onto the turbo inlet pipe. Then, remove the intake tube.

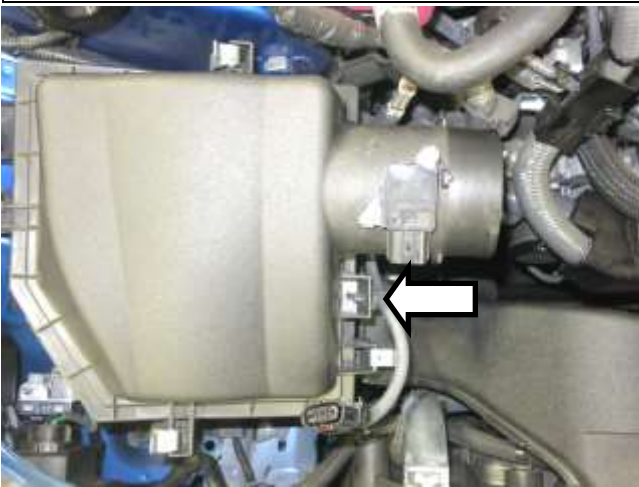

g. Unplug the MAF (Mass Air Flow) sensor harness. Then, use pliers or a small flat head screwdriver to release the wire tie holding the harness to the upper air box. Then, undo the 4 clamps holding the air box together.

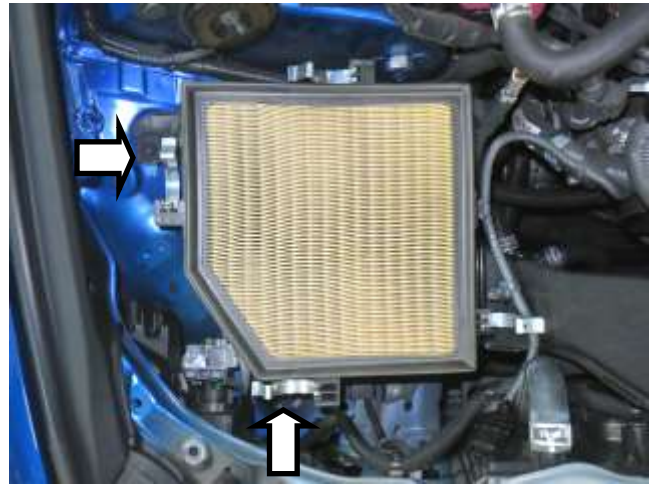

h. Remove the stock panel filter and the 2 M6 bolts holding the lower air box.



i. Flip the lower air box around. Remove the wire tie from the air box. Remove air box from vehicle.



j. Use a small Phillips head screwdriver to unfasten the 2 Phillips head screws and remove the MAF sensor from the upper air box. Do not discard any of the stock equipment removed thus far.

3. Installation of AEM® intake system.

a. When installing the intake system, do not completely tighten the hose clamps or mounting hardware until instructed to do so.



a. Insert the venturi into the AEM intake pipe. Make sure the cutout in the venturi aligns with the cutout in the intake pipe.



b. Attach the MAF sensor to the intake pipe using the 2 provided M4 bolts.



c. Attach the air filter, with the large hose clamp, to the intake pipe. Use an 8mm socket and ratchet, or a flat head screw driver, to tighten the hose clamp to 30 in-lbs.



d. Apply the supplied edge trim to the heat shield, as shown above.



e. Use a 10mm socket and ratchet to remove the M6 bolt, shown above.

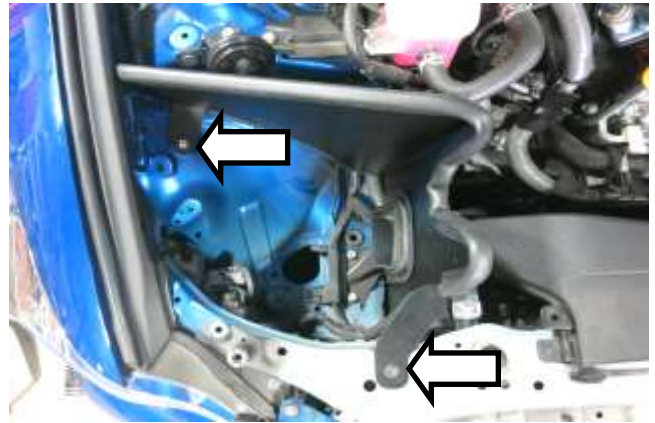

f. Place the heat shield into the engine bay, as shown above. Fasten the heat shield to the wheel well with the supplied M6 bolt and to the core support with the M6 bolt you removed in the previous step.



g. Screw the supplied soft mount to the engine bracket.



h. Place the tapered, reinforced coupler onto the turbo inlet pipe. Make sure the smaller diameter end is on the turbo inlet side. Then, place the 2 small hose clamps onto the coupler. Leave the hose clamp on the intake pipe side loose. Tighten the hose clamp on the turbo inlet side to 30 in-lbs.



i. Insert the assembled AEM intake pipe into the turbo inlet pipe coupler. Make sure the mounting bracket on the intake pipe aligns with the soft mount.



j. Adjust the intake pipe for best fitment, making sure it isn't hitting any surrounding components. Then, fasten the mounting bracket to the soft mount with the supplied fender washer and M6 flanged nut.



l. Tighten the hose clamp, holding the intake pipe to the coupler, to 30 in-lbs.



m. Reattach the breather hose to the port on the intake pipe.



n. Clip the MAF harness onto the heat shield with the two wire ties. Then plug the harness back into the MAF sensor.



o. If there is too much tension on the MAF sensor harness, you can adjust the position of the wire ties. Use a small flat head screwdriver to relieve tension on the wire tie. Then, you can slide the wire tie along the harness as necessary.



p. Replace the engine cover.



q. Replace the radiator shroud with the 9 push clips you removed in step 2a.



STOCK INTAKE INSTALLED



AEM INTAKE INSTALLED

4. Reassemble Vehicle

- a. Position all kit components for best fitment. Ensure that no components contact any unintended part of the vehicle.
- b. Check for proper hood clearance. Re-adjust components if necessary and re-tighten them.
- c. Inspect the engine bay for any loose tools and ensured that all fasteners that were moved or removed are properly tightened.
- d. Reconnect negative battery terminal and start engine. Let the vehicle idle for 3 minutes. Perform a final inspection before driving the vehicle.

5. Service and Maintenance

- a. AEM Induction Systems requires cleaning the intake system's air filter element every 100,000 miles. When used in dusty or off-road environments, our filters will require cleaning more often. We recommend that you visually inspect your filter once every 25,000 miles to determine if the screen is still visible. When the screen is no longer visible some place on the filter element, it is time to clean it. To clean, purchase our Synthetic air filter cleaner, part number 1-1000 and follow the easy instructions.
- b. Use window cleaner to clean your powder coated AEM[®] intake tube.

NOTE: DO NOT USE aluminum polish on powder coated AEM[®] intake tubes.

For technical inquiries
e-mail us at
sales@aemintakes.com
or
call us at
800.992.3000

AEM Air Intake System Warranty Policy

AEM® warrants that its intake systems will last for the life of your vehicle. AEM® will not honor this warranty due to mechanical damage (i.e. improper installation or fitment), damage from misuse, accidents or flying debris. AEM® will not warrant its powder coating if the finish has been cleaned with a hydrocarbon-based solvent. The powder coating should only be cleaned with a mild soap and water solution. Proof of purchase of both the vehicle and AEM® intake system is required for redemption of a warranty claim.

This warranty is limited to the repair or replacement of the AEM® part. In no event shall this warranty exceed the original purchase price of the AEM® part nor shall AEM® be responsible for special, incidental or consequential damages or cost incurred due to the failure of this product. Warranty claims to AEM® must be transportation prepaid and accompanied with dated proof of purchase. This warranty applies only to the original purchaser of product and is nontransferable. Improper use or installation, use for racing, accident, abuse, unauthorized repairs or alterations voids this warranty. AEM® disclaims any liability for consequential damages due to breach of any written or implied warranty on all products manufactured by AEM®. Warranty returns will only be accepted by AEM® when accompanied by a valid Return Merchandise Authorization (RMA) number. Credit for defective products will be issued pending inspection. Product must be received by AEM® within 30 days of the date RMA is issued.

If you have a warranty issue, please call (800) 992-3000 and our customer service department will assist you. A proof of purchase is required for all AEM® warranty claims.

Not legal for sale or use on any pollution controlled motor vehicle in California or states adopting California emission procedures. See AEMIntakes.com for CARB status on each part for a specific vehicle.